

Installation guide for Altro Whiterock™ Whiteboard

Installation quickfacts, installation and maintenance guides are available online at altro.com/techdocs

Handling and storing Altro Whiterock Whiteboard panels

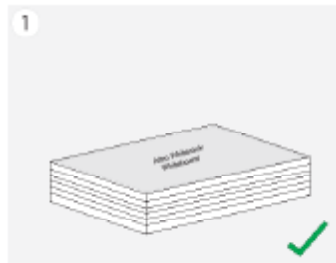

Altro Whiterock Whiteboard panels need to be stored flat.

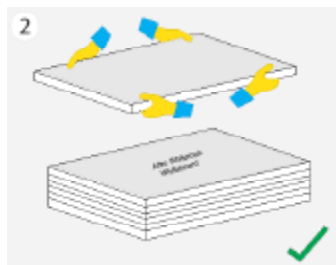

Keep flat when handling.

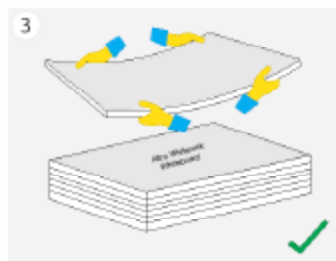

A slight bow in the panels is OK.

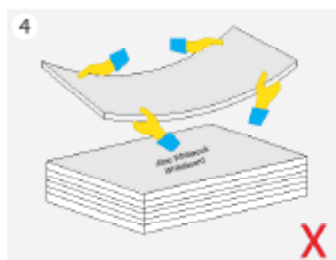

A large bend/bow in the panel can damage the film.

Cutting instructions

The most effective way to cut Altro Whiterock Whiteboard is with a track saw. It is recommended to use a carbide tipped blade with a minimum of 60 teeth. To ensure the cut does not damage the Whiteboard, remove the blue protective film from area of the cut. Place a strip of delicate surface painters tape at the location of the cut. Upon completion of the cut, the tape can be removed.

Prepare for a cut-out by removing the blue protective film around the cut-out location approximately 6" - 8". Apply delicate surface painters tape, cover the entire exposed area for marking the cut-out.

Once the cut-out has been marked on the painter's tape, proceed using pilot holes and finish the cut-out using a jigsaw or similar multi-tool with a fine-tooth blade. Carefully remove the painter's tape towards the cut-out opening (not away from it) when complete.

Thermoforming instructions

The thermoforming of Altro Whiterock Whiteboard can be accomplished using a Thermoformer. For proper thermoforming method, please consult the Altro Whiterock Installation Guide. It is recommended that only outside corners be thermoformed. Inside corners can be butted together and sealed with Sanitary Sealant.

VELCRO® Brand hook and loop tape installation method

Refer to our 1" VELCRO® Brand hook and loop guide for full details.

Welded installation

Note: If heat welding, this must be specified at the time of the order to allow for Whiteboard film to be offset from panel edge. Panels cut on site or panels without the Whiteboard film offset must be carefully prepared in order to successfully heat weld. It is recommended to follow the procedures at the end of this document for proper preparation of a heat-welded seam for panels without the film offset.

Items needed for this type of installation are - Altro Whiterock Whiteboard, appropriate Altro Whiterock adhesive, AltroFix 75 Spray adhesive, A815/2 double-sided foam tape, A809/05 Anti-static solution (liquid) and weld rod.

1. Select the location where the Whiteboard will be mounted.
2. Apply A815/2" double-sided foam tape on the wall so that it is centered at the seam, making sure to leave the paper face on the double-sided tape. (Make sure to use AltroFix 75 Spray adhesive at all locations that will receive tape).
3. Apply adhesive to back of panel making sure that the adhesive is held back 1" from the panel edge where the double-sided tape will hit it.
4. Fit panel on wall making sure to leave a 1/16"(2mm) gap between the Whiteboard and any adjoining panels. You may use finish nails (3d) to get the spacing correct.
5. Carefully pull back the edge of the Whiteboard panel from the wall and remove the paper covering the double-sided tape. Carefully set the panel onto the double-sided tape, assuring that the panel remains in the proper placement. Finish setting panel.
6. Clean both the seam area and the weld rod.
7. Use a 4mm narrow-flow welding tip (AST HWT 4MMN) for the welding of Altro Whiterock panels.
8. To determine proper temperature and speed for heat welding, test weld on a scrap piece of Altro Whiterock before proceeding. (It is advisable to use a different colored weldrod when welding the Whiteboard to signify where the Whiteboard section of the wall is located).
9. The heat weld may be trimmed flush when semi-cooled using a Mozart skiving/trimming knife.
10. When heat welding a small mock up must be done and inspected for client approval before proceeding with the entire installation.

If welding Altro Whiterock Whiteboard to another Whiterock Whiteboard panel the above steps will need to be applied to both panels. If welding Altro Whiterock Whiteboard to Whiterock, the Whiterock should be prepped as it normally would.

VELCRO® and other marks are registered trademarks of Velcro IP Holdings LLC. Used with permission.

Heat welding without the whiteboard film offset

1. Once the panel is sized and cut to the desired length and width, make a mark 1/16" off the seam edge both at the top and bottom of the panel.
2. With a straight edge and sharp utility knife, lightly cut through the whiteboard film at this mark along the entire seam edge. Alternatively, a purfling cutter can be used in lieu of the utility knife and straightedge.
3. Take care when removing this portion of the whiteboard film that is a 1/16" wide.
 - 3a. If edge of panel has adhesive residue after removing the film, clean with anti-static, mild detergent, denatured alcohol or similar.
4. Bevel the edge of the panel as you would for a traditional Altro Whiterock heat-welded seam.
5. Use normal foam tape placement and heat-welding practices as for a traditional Altro Whiterock heat-welded seam.
6. It is recommended to use a Mozart skiving knife to trim the weld rod versus using a spatula knife in order to not disturb the whiteboard film.