

# Floor to wall overlap transition

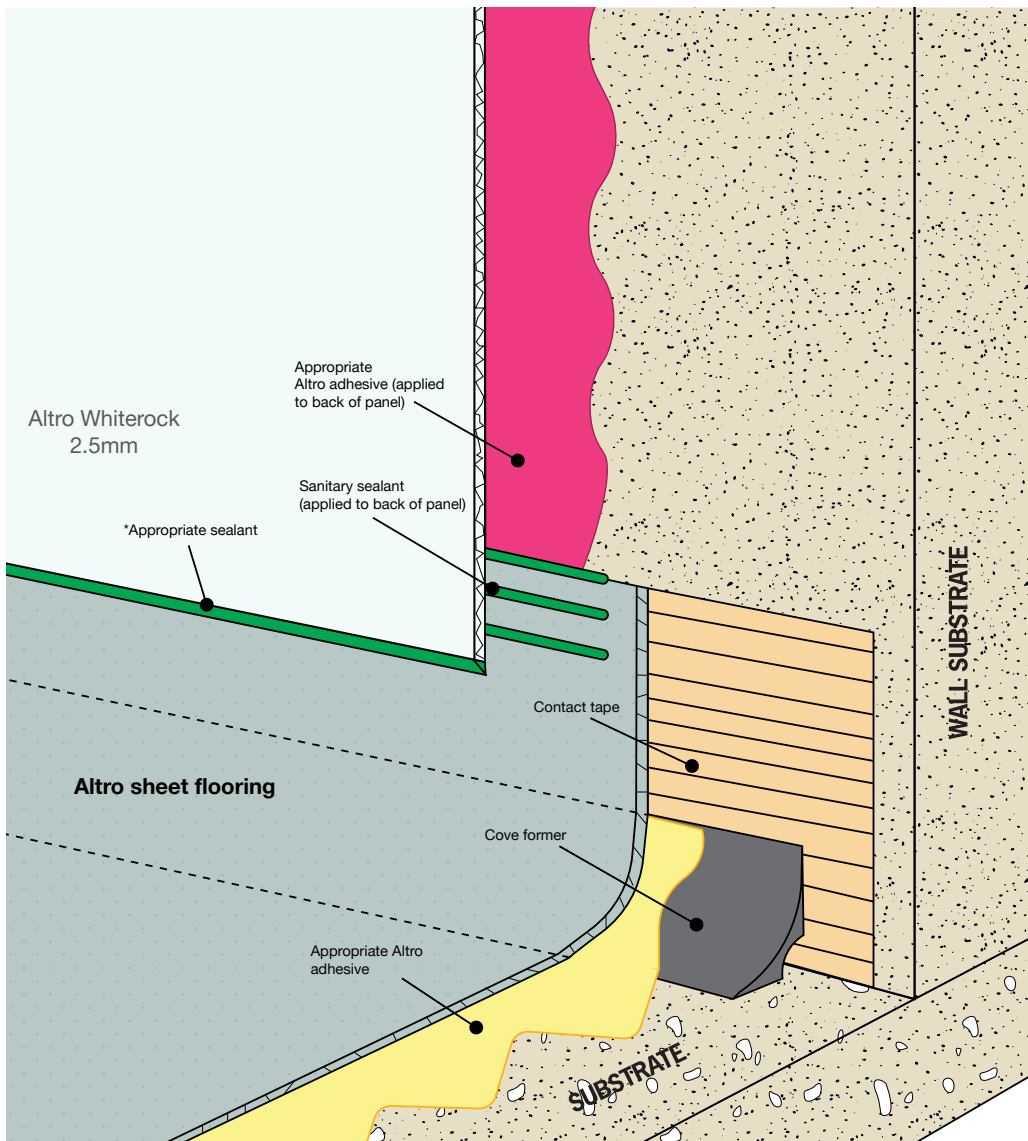

An overlap transition from floor to wall is our preferred installation method and is utilized in most installations. It is completed by installing the flooring 6" – 8" up the wall, dependent on cove size and installing the Altro Whiterock with a 2" overlap. The juncture is then finished with Altro sanitary sealant or tamper-resistant security sealant.

This installation technique is easier to install versus a heat-welded transition and offers enhanced security over water ingress. The overlap detail is an acceptable detail in most applications (showers, health care, veterinary, kitchens, and etc.).

*\*In behavioral and mental health facilities, tamper-resistant security sealant (previously referred to as pick-proof caulking) must be used per the manufacturers instructions. In other installations we recommend Altro sanitary sealant.*