



Designed for possibilities.  
Made for people.



# Altro Fortis Titanium™ 15 product datasheet brochure

Easy to install commercial wall covering

# Altro Fortis Titanium™ 15

Walls in commercial buildings can easily be scraped and bumped as people pass, or more serious dents can occur from wheeled traffic such as hospital beds and moving carts. Altro Fortis Titanium 15 has been specifically designed to shield drywall in these busy spaces while offering a quick and simple installation that does not require any specialty training.

Its lightly textured surface and homogeneous coloring reduces the visibility of scrapes should they occur. While the palette of six classic colors can offer a versatile and timeless aesthetic across a range of application areas.

Altro Fortis Titanium 15 is easy to clean and will keep the walls in your space looking newer and fresher far longer than paint. It's a smart choice in many commercial application areas in which a costly hygienic wall cladding installation is unnecessary.

Altro Fortis Titanium 15 is a full system that includes durable panels, easy-to-apply adhesive, color-matched sealant, and prefabricated corners. You don't need to be a skilled wall cladding installer to perform a quality installation of Altro Fortis Titanium 15. In fact, skilled laborers, drywallers, and maintenance staff will find the system quick and easy - saving the end-user considerable time and money.

## Typical applications

Corridors, utility areas, back-of-house, headwalls

## Features + benefits

- Installs easily without the need for professionally certified wall cladding installers
- Complete wall covering system with prefabricated corners, adhesives and color matched sealants
- Free of unsightly connector pieces for a clean, aesthetically pleasing appearance
- Reduces repair and maintenance time and costs while keeping commercial interiors looking new and fresh
- May be thermoformed on-site by trained installers but is not required for installation
- Twenty-year limited product warranty

1.5mm  
thick

4'  
width

9'10"  
length

panel  
format





Altro Fortis Titanium 15 shown in color Granite with Altro Lavencia LVT shown in color Sterling.

# A complete wall covering system

Altro Fortis Titanium 15 was engineered to be a complete, easy to install wall covering system. Our panels and prefabricated corners install quickly with sealant and with your choice of troweled or spray adhesive options.

Altro Fortis Titanium 15 saves you time and money on installation costs in areas that do not require hygienic, water-tight and costly cladding.

## Panels

- 4' x 9'10"

## Prefabricated corners

- 6" x 6" x 48" Internal - stocking
- 6" x 6" x 48" External - stocking
- 6" x 6" x 118" Internal - fabricated on demand
- 6" x 6" x 118" External - fabricated on demand

## Sealant

- Coordinates with panel colors
- You will need one cartridge of sealant per two panels including corners or three panels without corners. 90' - 100' approx. coverage per cartridge.

## Adhesives

- Altro W157 - water-based acrylic
- Altro W147 Spray - water-based acrylic blend

## Stainless steel corner (optional)

- 3" x 3" x 48"

## Fire Door Accessories (see page 9)

- Push plate
- Kick plate
- Full door fascia

*Your Altro representative can recommend handrails.*

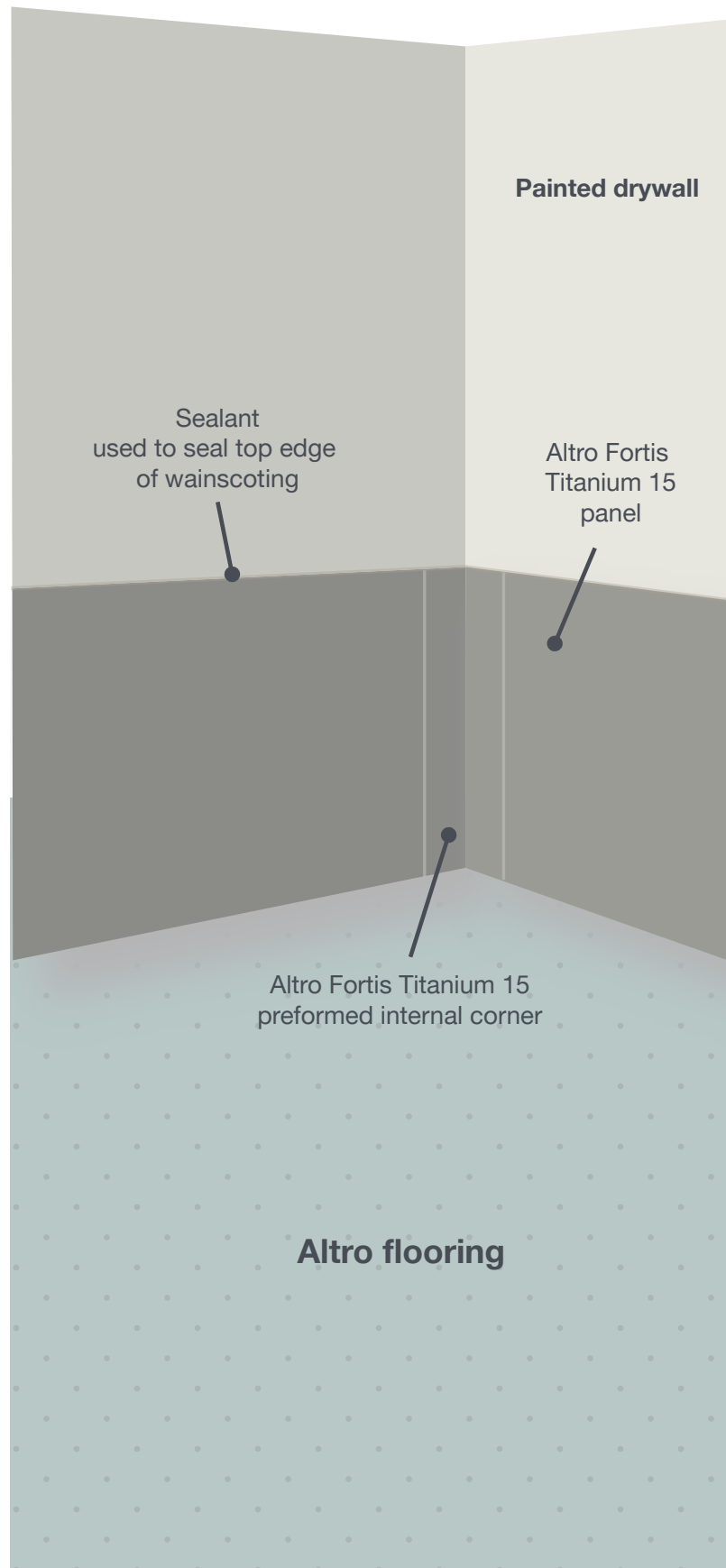

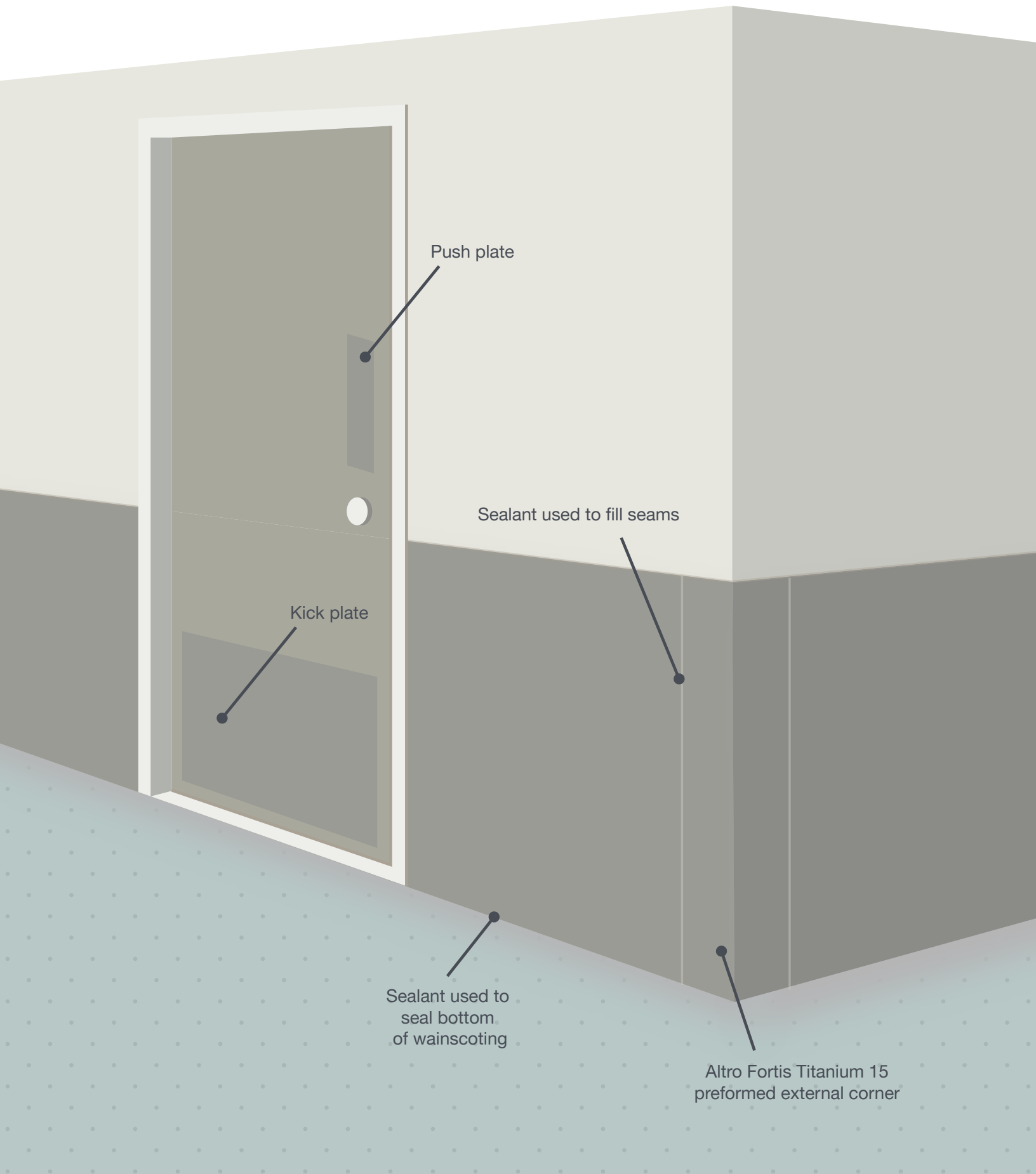

Push plate

Sealant used to fill seams

Kick plate

Sealant used to seal bottom of wainscoting

Altro Fortis Titanium 15 preformed external corner



### Candle

LRV 85

**Panels** W150/FT05

**Sealant** A805/05

**Internal corners** A526/12/05 (48") / A526/30/05 (118")

**External corners** A539/12/05 (48") / A539/30/05 (118")

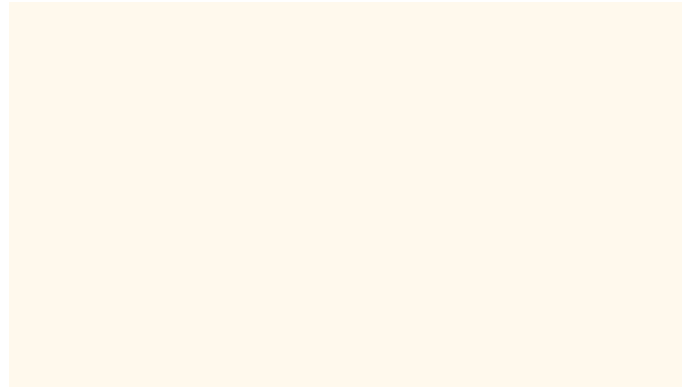

### Ivory

LRV 78

**Panels** W150/FT04

**Sealant** A805/04

**Internal corners** A526/12/04 (48") / A526/30/04 (118")

**External corners** A539/12/04 (48") / A539/30/04 (118")

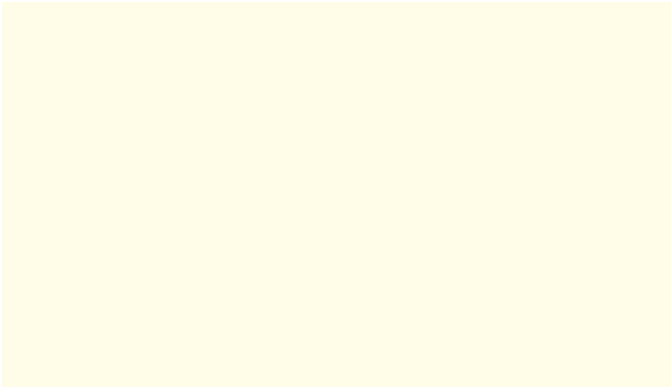

### Cotton

LRV 83

**Panels** W150/FT06

**Sealant** A805/06

**Internal corners** A526/12/06 (48") / A526/30/06 (118")

**External corners** A539/12/06 (48") / A539/30/06 (118")

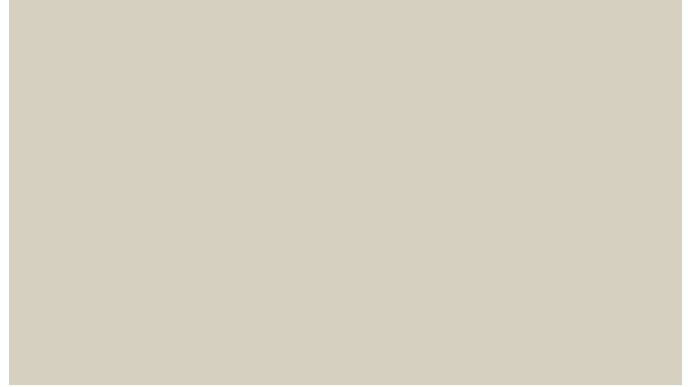

### Latte

LRV 58

**Panels** W150/FT03

**Sealant** A805/03

**Internal corners** A526/12/03 (48") / A526/30/03 (118")

**External corners** A539/12/03 (48") / A539/30/03 (118")



### Smoke

LRV 37

**Panels** W150/FT02

**Sealant** A805/02

**Internal corners** A526/12/02 (48") / A526/30/02 (118")

**External corners** A539/12/02 (48") / A539/30/02 (118")



### Granite

LRV 20

**Panels** W150/FT01

**Sealant** A805/01

**Internal corners** A526/12/01 (48") / A526/30/01 (118")

**External corners** A539/12/01 (48") / A539/30/01 (118")





Altro Fortis Titanium 15 shown in color Smoke with Altro Cantata shown in color Seal Gray.



Altro Fortis Titanium 15 shown in color Candle with Altro Cantata shown in color Bluebell.

# System accessories



## Color-matched sealant

Fills gap between abutting panels and corners. May also be used on perimeter  
See SKUs on page 5



## Altro W157 acrylic adhesive

Full spread, trowel application  
W157



## Altro W147 Spray adhesive

Spray application  
W147

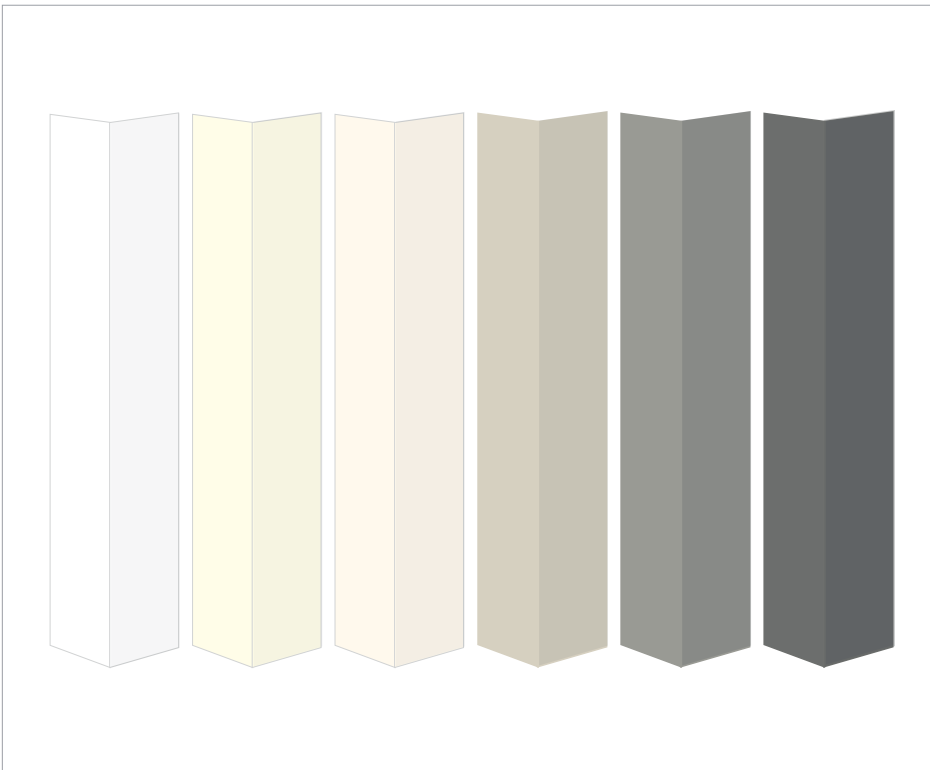

## Prefabricated corners

External and internal options available.  
6" x 6" x 48" or 6" x 6" x 118"  
See SKU chart below.



## 48" corner protector - stainless steel (optional)

A861/12 3" x 3" x 48"

48" prefabricated corners	Internal	External
Candle	A526/12/05	A539/12/05
Ivory	A526/12/04	A539/12/04
Cotton	A526/12/06	A539/12/06
Latte	A526/12/03	A539/12/03
Smoke	A526/12/02	A539/12/02
Granite	A526/12/01	A539/12/01

118" prefabricated corners	Internal	External
Candle	A526/30/05	A539/30/05
Ivory	A526/30/04	A539/30/04
Cotton	A526/30/06	A539/30/06
Latte	A526/30/03	A539/30/03
Smoke	A526/30/02	A539/30/02
Granite	A526/30/01	A539/30/01

\*118" are available as special order only.





Altro Fortis Titanium 15 shown in color Ivory with Altro Wood shown in color Spring Maple.

# Fire Door Accessories



Altro Fortis Titanium 15 as wainscoting in color Latte and AFT Fire Door Accessories (Push plate and Kick plate) in color Smoke.

Altro Fortis Titanium (AFT) 15 Fire Door Accessories are your solution to safeguard doors in high-traffic spaces. Crafted from the same resilient material as our renowned wall covering panels, these accessories offer:

**Versatility** - Choose from push plates, kick plates, or entire door fascias for comprehensive door protection.

**Tailored fit** - Push plates and kick plates are available in stocked and custom size options and door fascias are made to order to ensure a customized and seamless installation.

**Classic color palette** - Our palette of six classic colors will effortlessly integrate with any interior design scheme.

**Effortless installation** - Easily installs with AltroFix™ 75 Spray for ease and speed.

## Available in all 6 colors



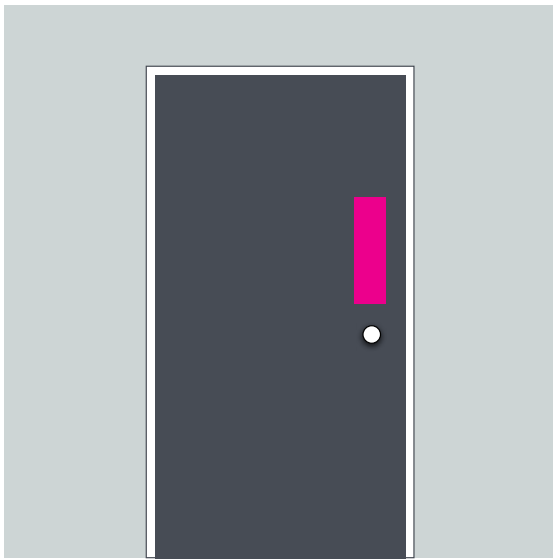

### Push plates

- 4" x 12" - In stock, all colors of AFT15
- 4" x 16" - In stock, all colors of AFT15
- 3" x 12" - In stock, all colors of AFT15
- Custom dimensions - made to order, inquire with your Altro sales representative.

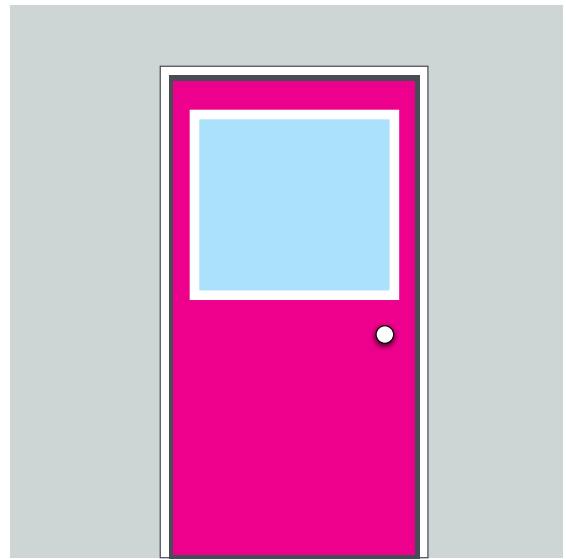

### Fascia (entire door)

We are able to accommodate custom dimensions of door fascias up to 48" x 118".

These fascias are made to order to each customer's specific need including cut outs for door handles, locks and windows.

A detailed door dimension drawing is needed to start a Fascia project and customers will be provided a PDF proof to sign off on before the order is processed.

Inquire with your Altro sales representative to start a Fascia project.

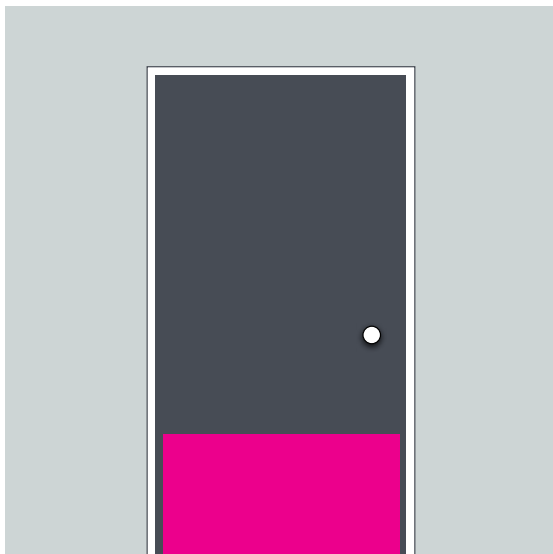

### Kick plates

- 34" x 24" - In stock, all colors of AFT15
- 40" x 24" - In stock, all colors of AFT15
- 46" x 24" - In stock, all colors of AFT15
- Custom dimensions - made to order, inquire with your Altro sales representative.

*Install with the Altro Fortis Titanium 15 wall covering system or on its own!*





Altro Fortis Titanium 15 shown in color Candle as wainscotting, AFT Fire Door Accessories (full door fascias) shown in Smokle with Altro Reliance 25 in color Stream.

# Installation guide

This publication is designed to provide technical information to assist in the installation of Altro Fortis Titanium™ 15. The recommendations herein are derived from actual field and laboratory testing and designed to ensure an efficient, professional, and lasting installation.

## Storage and handling

If storage temperature is below 68°F (20°C), Altro materials must be moved to a warmer place and allowed to reach this temperature before installation. The room temperature must not be below 68°F (20°C) and the wall substrate temperature between 65°F (18°C) and 80°F (27°C).

- Altro Fortis Titanium™ 15, adhesives, and accessories must be stored in enclosed dry conditions and not subjected to freezing or excessive heat. Heat above 140°F (60°C) will distort and damage the material, cold temperatures will make the material brittle and temperatures below 23°F (-5°C) should be avoided during the storage process.
- When stacking pallets they should not be stacked more than 8 pallets high and stacked flat without bumps or rolls and in a square and well aligned configuration, safety precautions should be taken to secure pallets to prevent shifting or falling.
- If more than one pallet of material is used, use material in sequence.
- Panels and all other materials should be moved into the acclimated worksite 72 hours prior to installation.
- Panels and all other materials must be checked for defects before installation. Do not install materials with visible defects.
- Check carefully to see that panels match in shade. If a shade match cannot be accomplished, do not install. Contact your Altro distributor.
- Wear appropriate safety equipment and eye wear and all other items that are required by local, state, and/or federal guidelines and regulations.

## Wall substrate preparation

Altro Fortis Titanium™ 15 panels must be installed on solid substrates. Ensure that the area is smooth, clean, dry, and flat. Any debris, loose paint, plaster, and dust must be removed.

Very absorbent / porous substrates (particularly plaster finishes and very dusty or unprimed sheetrock) must have one coat of paint primer (Valspar, Glidden, Benjamin Moore, or equal) applied to the surface a minimum of 12 hours prior to the installation.

## Concrete and concrete masonry units

All concrete or CMU walls must be made smooth with appropriate patching compound because the unevenness of the wall may cause telegraphing. Altro strongly suggests that a test area be done to ensure desired adhesion is achieved.

## Cutting and fitting

Altro Fortis Titanium™ 15 panels can be cut by many different means. The most effective cutting method is by using a carbide-tipped fine-toothed circular saw.

For cut-outs, such as switches, outlets and rectangular shapes use a jig saw or oscillating multi tool. For pipe penetrations or round shapes, use a step drill bit or fine tooth hole saw.

Be sure to leave a minimum 1/16" gap at all moldings, openings, fastener holes, terminations, and panel edges. Do not fit panels tightly. Always wear proper personal protective equipment when handling, cutting, and installing panels.

## Prefabricated internal and external corners

Preformed corners are 6" x 6" with available heights of 48" and 118". Wipe back of corner with anti-static spray and a cloth prior to adhesive application.

When using Altro W157, trowel adhesive on the back of the panel from side-to-side and from top to bottom. The Altro W147 spray adhesive can be applied to the back of the corner or the wall substrate. Protect surrounding areas from overspray. Use a 3-wheeled wall roller to roll entire corner to ensure proper bond to wall substrate.

## Adhesives

Altro W157, a water-based acrylic adhesive, is suitable for surfaces in dry, climate-controlled areas and may only be used with absorbent substrates (drywall, wood, porous concrete/block). The recommended trowel notch is PRB 1/8th square notch. All substrates must be smooth to ensure proper adhesive bond.

Altro W147 Spray, a versatile water-based acrylic blend spray adhesive, is suitable for surfaces in dry climate-controlled areas and for most all absorbent and non-absorbent surfaces. All substrates must be smooth to ensure proper adhesive bond.

- (A) All gypsum joint compound needs to be primed with a paint primer.
- (B) Very absorbent surfaces must be primed with one coat of a PVA primer.



- (C) A bond test is advisable to check adhesive does not react with paint.
- (D) Altro W157 should not be used for bonding to moisture resistant substrates.
- (E) Test for moisture with a GE Protimeter, which should give a maximum reading of 16% wood moisture equivalent (WME).

## Panel installation

For full height installations it is recommended to work off a datum/level line. This line is used for the calculation of measurements for ceiling/floor height, outlets, pipes, etc, and will ensure the following panels are installed plumb.

Substrate	Altro W157	Altro W147 Spray
Drywall min 5/8" thick	A, B, and D	A and B
Plywood min 3/8" thick	B and E	B and E
Metal	D	Acceptable
Plaster	B and E	B and E
Smooth concrete	B	B
Painted	D	C

For wainscot installations a datum/level line should be established at the specified height.

Prepare the first panel by making any necessary cutouts or scribe the edge to fit the preformed inside or outside corner if applicable. Allow 1/16" gap around abutments.

Wipe back of panel with anti-static spray and a cloth prior to adhesive application. When using Altro W157, trowel adhesive on the back of the panel from side-to-side and from top to bottom.

Altro W147 spray adhesive can be applied to the back of the panel or the wall substrate. Protect surrounding areas from overspray. Adhesive must be installed to within 1/8" of panel edges.

If overlapping any existing flooring or non-porous base system apply 3 - 1/4" beads of sealant to back of panel along the bottom 2" of the panel.

Use a 3-wheeled wall roller to roll entire panel to ensure proper bond to wall substrate.

**Note: Backfill may be needed just above coved flooring to limit telegraphing.**

## Butt joint seams

Altro Fortis Titanium™ 15 panels and prefabricated corners can be specified and installed with butt joints seams and must only be used in temperature-controlled environments of 75°F +/- 5°F (24°C +/- 3°C) during and after the installation.

Butt joint seams are to be 1/32" wide.

## Color matching sealant seams

Altro Fortis Titanium™ 15 panels and prefabricated corners can be specified and installed with color matching sealant. When the seams are caulked a space of a minimum of a 1/16" is required.

Spacers must be used during the installation to ensure a consistent seam. The seam is filled with a color matching sealant after the adhesive has fully cured.

Once panels and corners have been properly installed with appropriate spacing and adhesive has cured the color match sealant can be applied to the seam.

1. Apply masking tape on each side of the seam, this prevents excess sealant from getting on the panel.
2. Apply approximately 1/8" bead of color matching sealant to the seam. Be sure enough is applied to completely fill the seam.
3. Immediately remove surplus sealant with putty knife or similar ensuring it is flush with the panel.
4. Remove masking tape.
5. Remove any excess sealant from panels immediately with a clean cloth and warm water.

## Fixture installation

Allow adhesive to set a minimum of 24 hours or until panels are firmly bonded to wall prior to fixture installation. When installing fasteners through a completed Altro Fortis Titanium™ 15 installation make sure to leave a minimum 1/16" gap all the way around the fastener to allow for panel expansion and contraction.

## Sealing Altro Fortis Titanium™ 15 panels

Place a continuous bead of sealant along all panel edges and protrusions upon completion of installation. To remove excess sealant use denatured alcohol immediately.

## Cleaning

Clean up any wet acrylic adhesive and/or wet spray adhesive with soap and water. After installation, remove protective plastic coating and wipe down with anti-static solution. Panels may be cleaned with AltroClean 44 cleaner and a microfiber towel.

Continue with regular maintenance as described on maintenance page.

# Illustrated installation guide

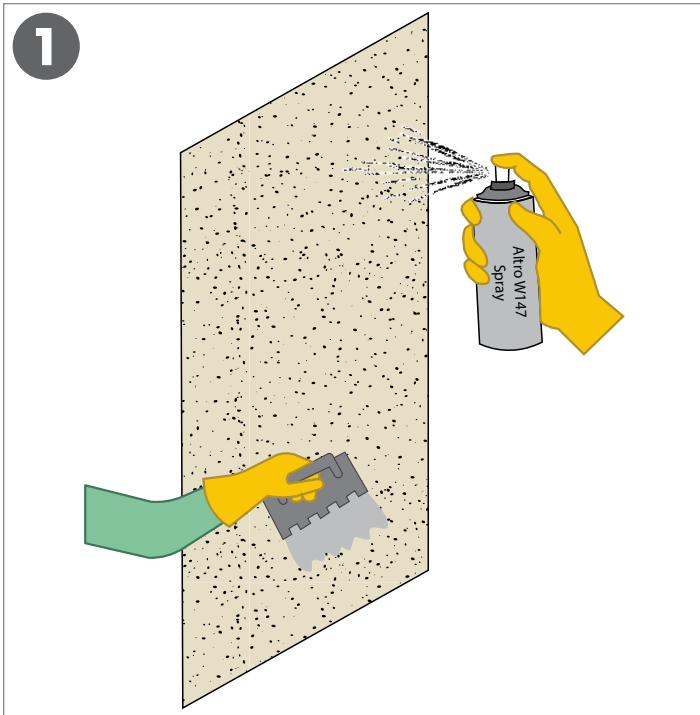

1. Apply adhesive as directed in the Altro Fortis Titanium 15 installation guide. Adhesive can be applied to the wall or back of panel.

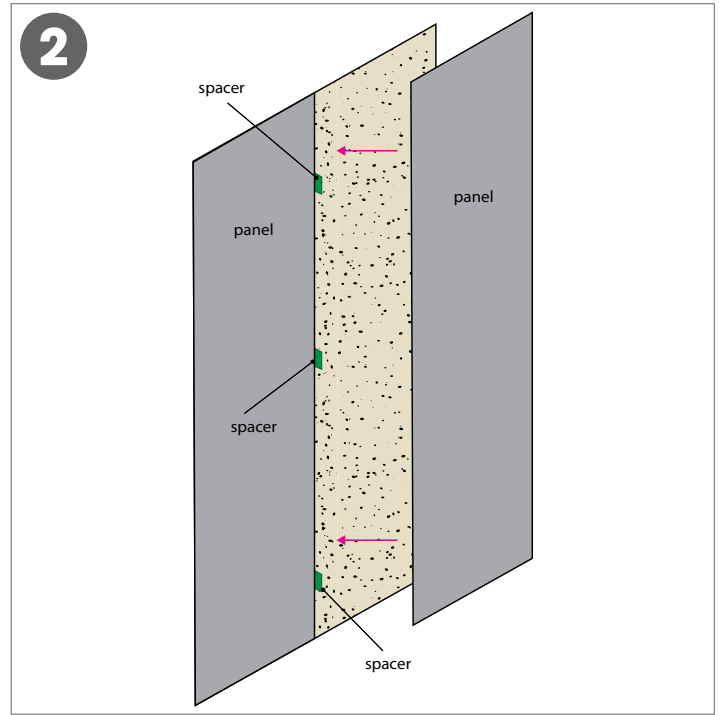

2. Install panels per installation instructions. Seam is not to be less than 1/16". Use a spacer to ensure uniform seam.

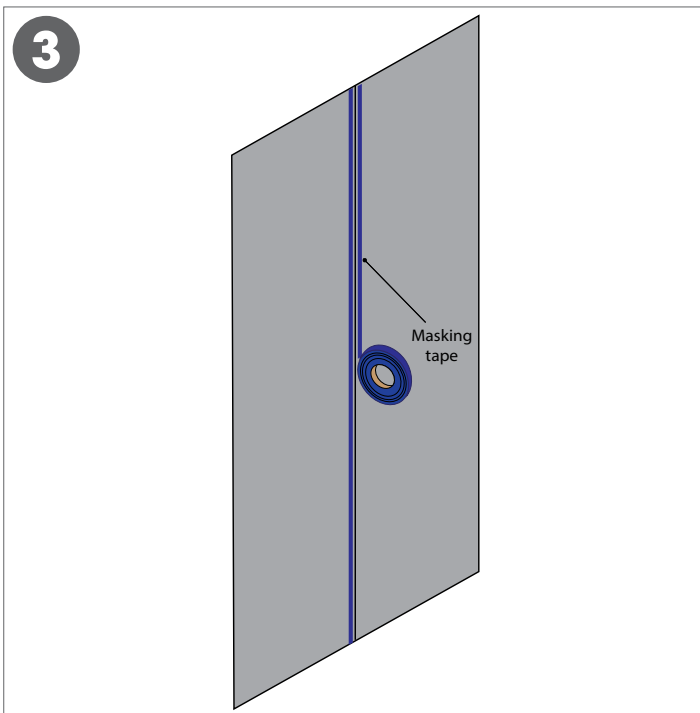

3. Allow adhesive to fully cure. Place masking tape on each side of the seam to prevent excess sealant from getting on the panels.

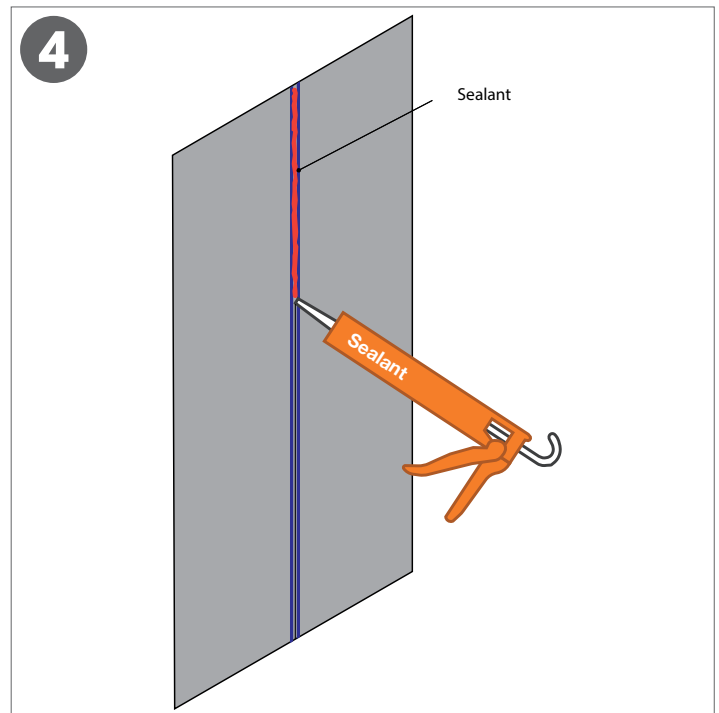

4. Apply 1/8" bead of sealant to the seam. Ensure that an ample amount is applied and the seam is completely filled. Approximate coverage is 90'-100' per tube.

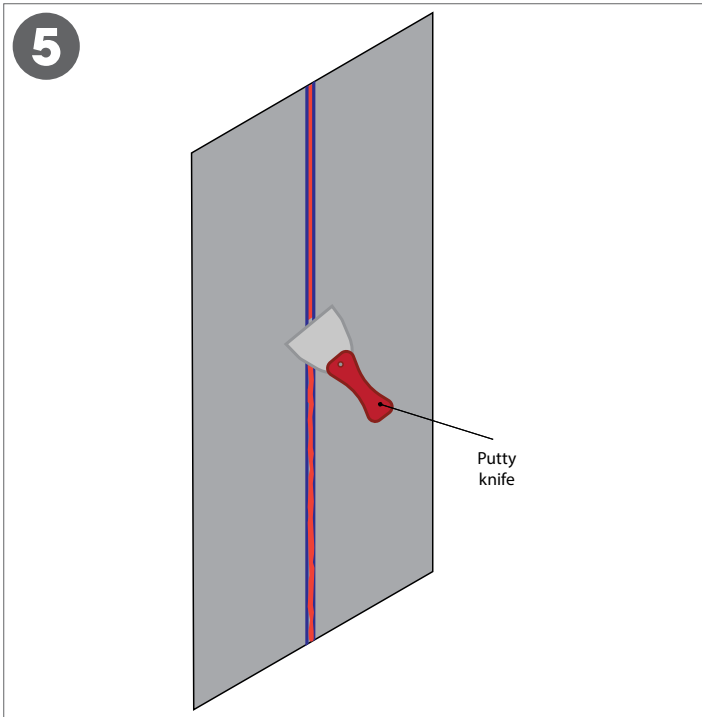

5. Immediately screed off the excess sealant. Ensure it is flush with the panels.

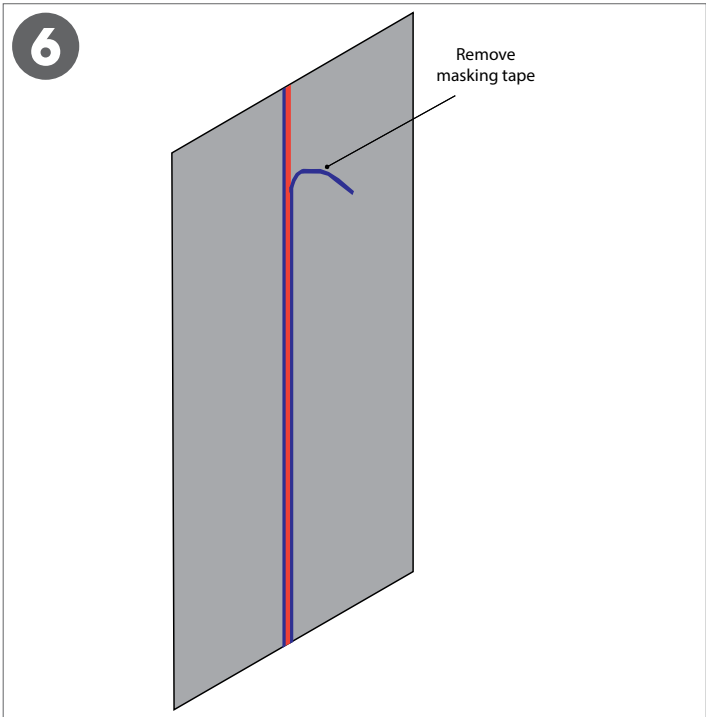

6. Remove all masking tape.



Altro Fortis Titanium 15 shown in color Ivory with Altro Wood shown in color Spring Maple.

# Maintenance guide

## Initial cleaning

Once all panels and joints are installed, remove the protective film and clean all surfaces with an anti-static solution. This is required as the panel will have static build up and any dust in the atmosphere will adhere to the surface of the panel.

Continue with regular maintenance.

## Regular maintenance

- Wall panels can be cleaned with a diluted soap/detergent solution, such as PVC wall cleaner (for stubborn stains) or AltroClean 44.
- Use a lint-free, non-woven wipe or a polyester knit wipe. Both are extremely low in particle generation.

- When cleaning the panels we recommend the temperature of water does not exceed 140°F (60°C).
- To reduce the build-up of static, cleaning the panels with an anti-static solution or a diluted soap/detergent solution is recommended.
- Some cleaning agents may adversely affect wall panels. See Altro's chemical resistance chart for reactions to common chemicals at [www.altro.com/techdocs](http://www.altro.com/techdocs).
- Do not use cleansers containing abrasives or solvents.
- Pressure washing is not recommended.

The following maintenance products are available to purchase through Altro



**AltroClean 44**  
44Cleaner



**PVC Cleaner**  
A859/325







**Anti-static solution spray bottle**  
A809



**Anti-static solution refill**  
A809/05

Labels may indicate that they are exclusively for Altro Whiterock. Please note, cleaning agents may be used for all Altro wall panels.

Thickness	1.5mm   .060"		
Dimensions	4' x 9' 10"   1.22m x 3.0m		
Weight	17.6 lbs   8 kg		
Warranty		20 years	
Life expectancy		25 years	
Impact resistance		ASTM D5420 Gardner Impact	52 inch lbs <i>tested as wall assembly</i>
Fire and smoke performance		CAN/ULC - S102.2 ASTM E84-08	Tested Class A
VOC emissions		CA 01350	Pass
Density	ISO 1183	1.39g/cm <sup>3</sup>	
E-modulus of elasticity	ISO 527	3000	
Flexural strength	ISO 178	73 MPa	
Tensile strength	ISO 527	52 MPa	
Shore-hardness D	ISO 868	78	
Surface resistance ROE (Ω)	DIN IEC 60 167	>2.00E+14	
Dielectric strength	DIN IEC 243	16.8 kV/mm	
Dielectric constant	DIN 53483	3.0 - 3.6	
Linear thermal expansion	ASTM D696-16	3.31E-05 - 3.61E-05 /F° 5.96E-05 - 6.49E-05 /C°	
Thermal conductivity	EN 12524	0.16 W/mK	
Water absorption	ISO 62	0.1	
Composition	Extruded PVCu with a lightly textured surface emboss		

**LEED facts** 

LEED v4 This product may help contribute to the following credits

---

Altro Fortis Titanium 15 **2**

---

 Environmental quality  
Low emitting materials, walls **1**

---

 Environmental quality  
Low emitting materials, adhesives **1**

Discover more of our sustainability story and credentials at [altro.com](http://altro.com)



Order samples 24 hours a day at [altro.com](http://altro.com) and [materialbank.com](http://materialbank.com)

Altro and Altro Fortis Titanium 15 are trademarks of Altro Limited. Book content was correct at time of print. Altro reserves the right to change any detail. Please consult your sales representative for the latest product information.  
© Copyright Altro USA 2024

Discover more online!



Maintenance guide



Warranty form



Literature

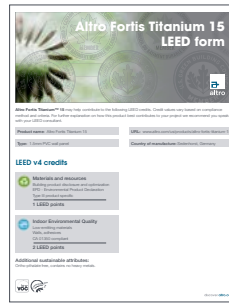

LEED form

## Even more great resources!

- BIM components
- SDS sheets
- Detail drawings and CAD files
- High-resolution swatch downloads
- Photo galleries - [www.altropics.com](http://www.altropics.com)
- Solutions by area type - ORs, labs and cleanrooms, kitchens, senior living and more!

Follow us



FORTIS DATA

📞 USA 800 377 5597

📞 CANADA 800 565 4658

✉️ [support@altro.com](mailto:support@altro.com)

🌐 [www.altro.com](http://www.altro.com)

Content was correct at time of print. Altro reserves the right to change any detail. Please consult [www.altro.com](http://www.altro.com) or your local Sales Representative for the latest product information.