

altro

Framing and detail diagram for Altro Whiterock recessed shelf

updated 05/14/2020

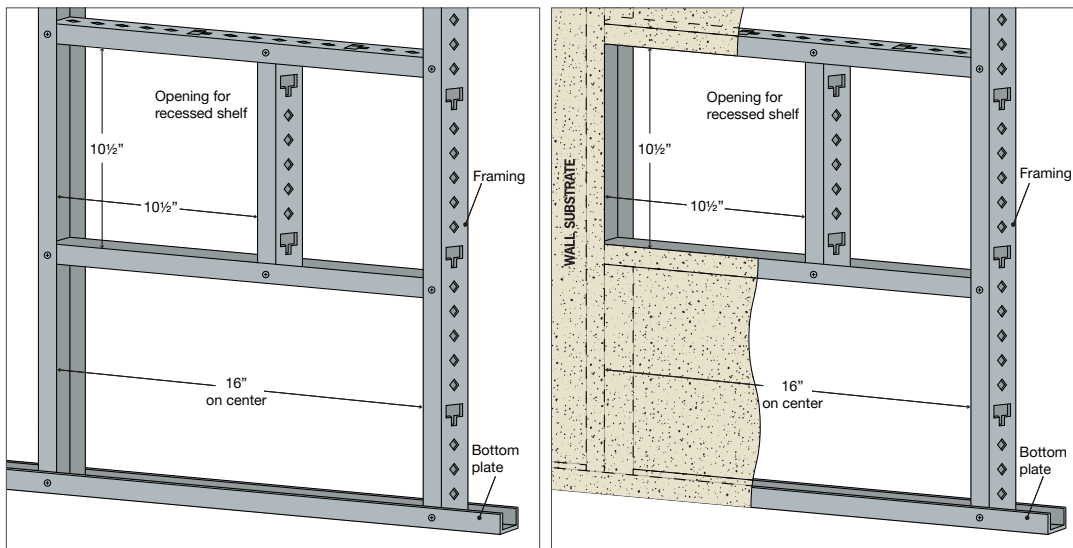

Recommended framing and support for Altro Whiterock recessed shelf A900.

10 1/2" x 10 1/2" opening allows for a 1/4" spacing around the 10" x 10" body of the recessed shelf.

In a behavioral health application it is strongly recommended to install plywood or a similar type material behind the shelf for additional support.

Please see "Installation guide for Altro Whiterock™ Recessed Shelf A900" for detailed installation instructions.

