



altro

Pencil cove detail diagram

The pencil cove installation method is an extremely secure way of detailing showers and wet areas. Altro WhiteRock is flush against the flooring to ensure there is no opportunity to pick at the finishes. The bottom edge of the wall panel is chamfered and caulked with tamper-resistant security sealant.

This installation method ensures the room is both watertight and tamper-resistant.

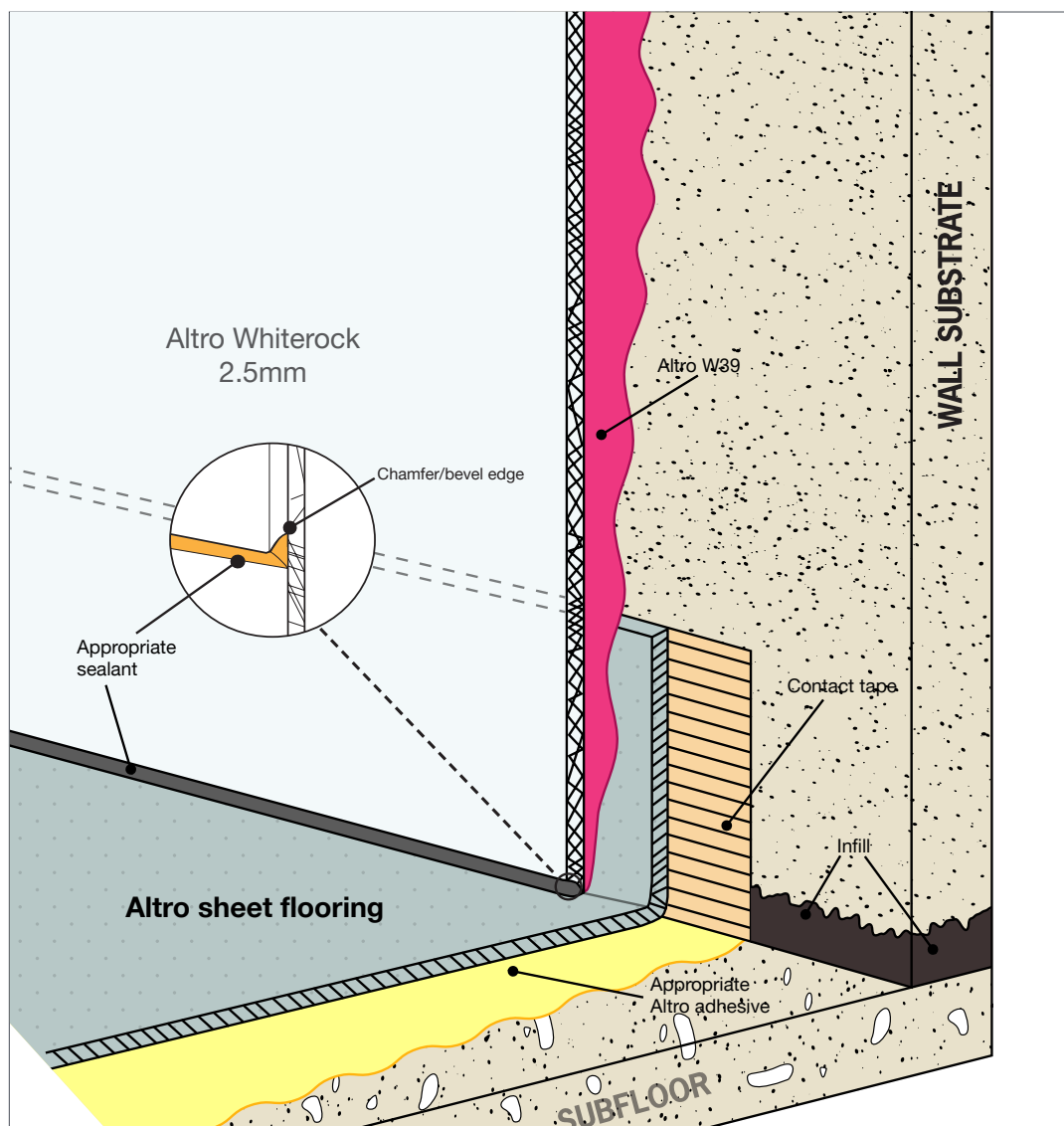

TIPS

- It is important to press vinyl tightly into the crease where the floor and wall meet when installing.
- When installing Altro WhiteRock on an unlevelled floor, you will have to scribe the panels to the floor.
- Weld inside and outside corners in vinyl before Altro WhiteRock is installed.
- Important to use primer before applying tamper-resistant security sealant.
- Altro W39 adhesive is the recommended choice for all Altro WhiteRock installations across all BMH care levels.