

altro

Installation instructions for Altro Lavencia™ Click

updated 08/29/18

Before you start

- Altro Lavencia Click is normally loose laid without adhesive, although full spread gluing is also possible; gluing may be required and recommended in wet areas or those with heavy rolling loads, please consult Altro technical department if this applies to your installation.
- Altro Lavencia Click must be acclimatized. Store flat and fully supported during shipping and storage. Remove material from packaging, spread out if possible and allow to condition in room where installation is to take place at a constant temperature of 68° to 77° degrees Fahrenheit (20° to 25° C) for a period of 24 hours prior to installation.
- Check Altro Lavencia Click for possible defects prior the installation. Complaints can only be accepted before installation. Slight variations in color and structure are designed to enhance natural appearance. Mixing the tiles creates a more natural appearance.
- Be aware that when exposed to excessive temperatures and direct sunlight Altro Lavencia Click if loose laid may expand and contract causing problems with the locking system. Please consider these exposures when choosing your product and deciding if the product will require it being glued down in place.
- In facilities where walkers, wheel chairs are present, or in facilities with movement of heavy displays, racks, dentist chairs patient beds, etc. These types of installations may exert extreme stress and compromise the locking system. Therefore it is recommended that these installations be installed glued down. Please consult your Altro representative or Altro Technical Services.
- Determine if there is a need for noise reduction. Many residential applications like condos and senior living facilities require noise suppression between floors. Altro recommends using Altro Hush acoustic underlay for Altro Lavencia Click (sub-floor mat) where there is a need for noise reduction between floors.
- The use of a pull bar and tapping block is recommended to ensure a successful install.

- Altro Lavencia Click provides a very tight fit. Proper care must be used to ensure all seams are tight at end of install. An unprofessional installation or use of improper tools can result in damage to the locking profiles.
- For larger areas of flooring, expansion gaps should be provided. Place expansion gaps in areas with significant room narrowing i.e. hallways and in door jambs. Cover the expansion gaps with suitable coverings.

Subfloors

- Although Altro Lavencia Click is water-resistant, they are not to be used as a moisture barrier. Your subfloor should be completely dry prior to installation of the vinyl floor.
- ASTM F-2170 relative humidity (RH) test results must not exceed 90%.
- Subfloors must be structurally sound, solid, stable, level, plumb and true to a tolerance in plane of 3/16" in 10 feet (6 mm in 4m). Cracks and holes must be filled with a fast setting cement-based polymer modified patching compound or equivalent. Any unevenness over 3/16" (4.7mm) must be sanded down or levelled. The surface must be clean of dirt, oil, glue residue etc. Carpet staples or adhesive residue should be removed prior to installation. Voids or humps in the subfloor will prevent the tiles from locking properly.
- Do not install Altro Lavencia Click over soft subfloors such as carpet or foam underlayments.
- Concrete shall be constructed per the guidelines contained in the ACI (American Concrete Institute) 302.2R-06: Guide for Concrete Slabs that Receive Moisture-Sensitive Flooring Materials <https://www.concrete.org>
- Altro Lavencia Click can be installed on existing firm floors (Linoleum, PVC...), but all textile floors must be removed. When laying the floor over existing ceramic tiles first level with a fast setting cement-based polymer modified patching compound.

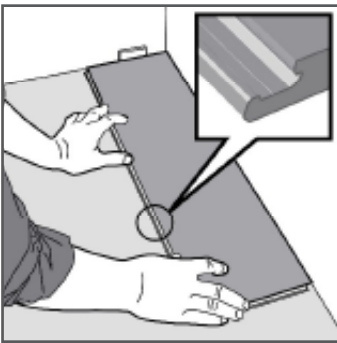

1. Start with the first tile in the left corner of the room, tongue-side facing out from the wall on the length and to the right on the width. Work from left to right.

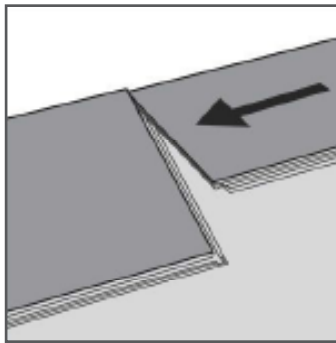

2. Position the following tile as an exact extension of the first one. Place this tile gently and tight to the short end of the first one.

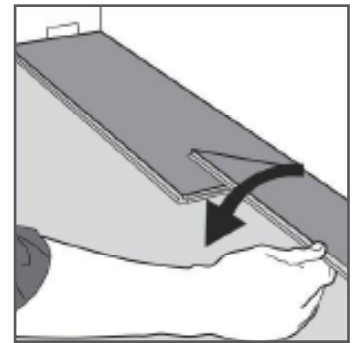

3. Lower the tile down in a single action movement. Make sure the planks are tight against each other. Afterwards, press or slightly knock at the short end just installed.

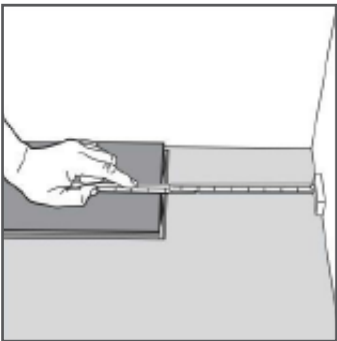

4. Measure and cut to fit the last tile of the row. To do this you can use a utility knife to score the surface at the appropriate point and then break the tile over an edge. Alternatively a vct tile cutter or Miter saw can be used.

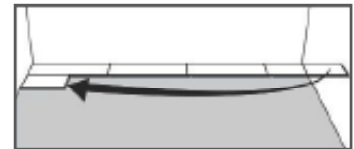
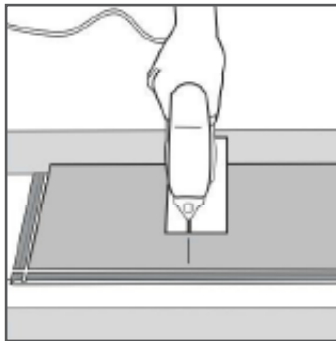

5. Begin the second row with the cut-off end from the first row.



6. Allow at least a 6" stagger for end seams

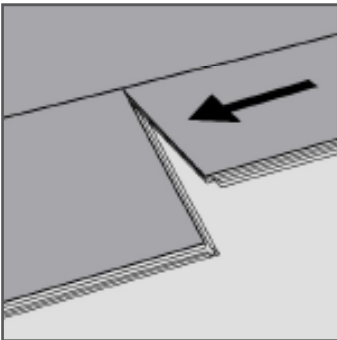

7. Starting with the first plank in the row, raise the plank at a 45° angle, insert the lengthways tongue into the lengthways groove.

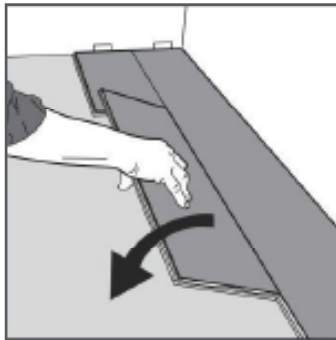

8. Lower the tile while holding the two together until they are flat and tightly together.

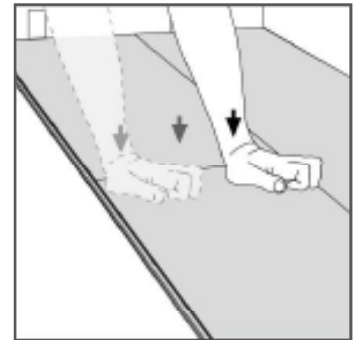

9. Close the joint using hand pressure, tapping block or pull bar.

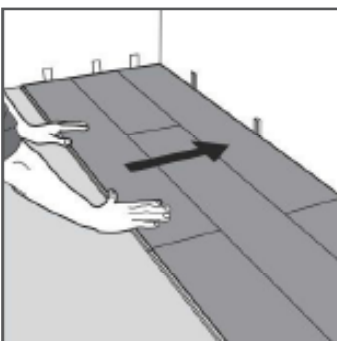

10. Adjust the distance to the wall by pulling floor out and placing spacers of 5-6mm against the wall.

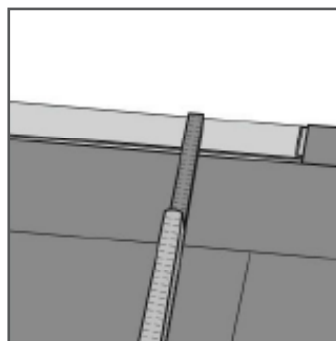

11. Minimum tile width should be at least 5cm. Remember to allow for a gap of 5-6mm to wall. Put a spacer before measuring.

To shorten wooden doorframes:
Position a loose plank face down close to the doorframe and cut with an undercut or jamb saw.

Install new base or moldings;
fasten these to the wall, never to the floor.

Measurements

- Agree on which direction the floor boards should run since this influences the visual size ratio of the space. Installation parallel to the longest wall or the main light-source is recommended for best visual effects.
- Pre-plan the floor by measuring the room first. If the width of the last row is less than 2" inches (5 cm) lay out the room to achieve that the first and the last tile are equal in width.
- Snap lines on the substrate to identify the layout reference points - tiles should be set using this reference to ensure tiles are aligned and will lock together correctly.
- In large areas where flooring will span in excess of 40' long, an expansion gap should be used. Otherwise place expansion space in and under the door thresholds. Cover the expansion space with suitable coverings.
- Do not tight fit the tile to door casings, walls, or other abutments, undercut door casings for tiles to fit underneath and leave a minimum 3/16" inch space at all other abutments that cannot be undercut or placed on top of the tile.

Installation with different production runs

Vinyl floors can have slight color variations in between production runs. Before starting the installation, it is best to check the production run # which is indicated on the label on the carton. If you find that you have cartons from different production runs, it is highly recommended that you open cartons and install a mix of tiles from each different production run on your floor. This will result in a more natural looking floor.

Installation over radiant heated subfloors

Altro Lavencia Click can also be installed on a radiant heated subfloor. Please consult your Altro representative or Altro technical if you have any questions.

Installation in direct sunlight/heavy load areas

For application in direct sunlight or exposure to excessive heat or in areas with heavy rolling traffic i.e. Dentists chairs, wheelchairs or dollies it is recommended to glue Altro Lavencia Click down and permanently into place in these areas using EcoFix 25E or EcoFix65 Spray.

Using EcoFix 25E adhesive

- ASTM F-2170 relative humidity (RH) test results must not exceed 90%.
- Use EcoFix 25E adhesive wherever possible, allow the adhesive to dry to a pressure sensitive state before installing tile. When a wet set, hard set adhesive is needed use EcoFix 20E hard set acrylic adhesive.
- Apply adhesive with a 1/32" deep x 1/16" wide x 1/32" notched trowel.
- Allow adhesive ample open time* to "gas off" and tack-up before proceeding to install tile. Installation too late in the pressure sensitive stage of the adhesive reduces the strength

of the bond and can cause the lines of the adhesive to show through to the surface of the flooring.

- Flooring must be rolled in its entirety with a 100 lb. roller.
- The adhesive open time, working time, set and curing time will depend on the type of substrate, its absorbency, the temperature and the and the air humidity in the premises.
- Prohibit heavy traffic and pallet jack type rolling loads on floor tile for 72 hours after installation.

Using EcoFix 65 Spray adhesive

- ASTM F-2170 relative humidity (RH) test results must not exceed 95%.
- Before use, be sure to shake can of EcoFix 65 Spray well.
- Spray from a standing position, holding can 20-30 inches (50-70cm) from floor.
- Protect walls from overspray with a spray shield of a piece of cardboard.
- Allow adhesive to dry to the touch. Test this by lightly touching the adhesive - there should be no adhesive transfer to your fingers. Too much adhesive or high humidity will increase dry time.
- Open working time after tack is 4 hours.
- Roll floor immediately with a 75-100 lb. roller.
- Floor is open to all traffic immediately after installation.
- Clean up with a damp cloth for wet overspray.
- Use mineral spirits for dry overspray.