

Installation and maintenance guidance

Altro Fortis Titanium 15

October 2025

This fitting guide, whilst compiled to the best of our knowledge is for guidance only, Altro cannot be held responsible for any faults which may occur. If in any doubt, contact the technical services department to answer any queries you may have. Tel: 1800 673 441

Description

Altro Fortis Titanium 15, a semi-rigid extruded PVCu wall cladding, is designed for indoor use only in high-traffic public areas prone to impact and scuff damage. This cladding system is versatile, capable of installation over various sound substrates commonly employed in internal wall construction. It proves suitable for both new constructions and refurbishment projects. It is a fully adhered system equipped with tapes to facilitate easy installation. Joints can be either thermally welded or finished using colour-matched mastic (supplied by others). Thermal forming to all corners is recommended, minimising joints, and ensuring ongoing hygiene throughout the installation's lifespan.

Panels come in a thickness of 1.5 mm and are supplied 3000mm length x 1220mm height. They are covered with a protective film on the surface, which can be retained until the area is prepared for utilisation. This film serves the dual purpose of safeguarding the new surface from dust accumulation while accommodating other trades working in the vicinity.

Altro Fortis Titanium 15 PVCu panels have a maximum service temperature of 60°. Although the panels can be applied in most areas, they should never be installed near to a direct heat source (cookers, oven ranges, wall mounted griddles etc) where naked flame or severe heat would cause distortion or damage to the surface. For these situations, Altro recommends using stainless steel panels.

If a layout drawing highlighting areas where heat may be of concern can be provided, specific advice can be provided as to the best combination of materials to use.

On delivery, sheets should be checked for any possible faults prior to installation. Claims against guarantee for colour, batch or obvious material defects will only be considered if the wall sheets have not yet been installed.

Ensure that the material used in any one area is from the same manufacturing batch, and on large projects where multiple sheets are used, it is best practice to use sheets off of one pallet before moving on to the next numbered pallet.

Suitable substrates / fixing methods

Substrate	AltroFix Adhesive-Free tape system	AltroFix W157 Acrylic adhesive	AltroFix W157 Acrylic adhesive and full tape system
Plasterboard min 10-13mm (c)	✓	✓	✓
Cement sheeting (c)	✓	✓	✓
Cement render	✓	✓	✓
Painted surface (b)	✓	✓	✓
Structural plywood (a)	✓	✓	✓
Solid plaster (a)	✓	✓	✓
Metal/Aluminium	✓		
Ceramic tiles (d)	✓		
Existing PVC walling	✓		

Note: For guidance on using W139 2-part water resistant adhesive on non-absorbent substrates such as metal, ceramic tiles and existing PVC walling, please reach out to Altro Technical support.

- (a) Ensure the surface is dry. If uncertain, use a protimeter or a similar tool to conduct a test.
- (b) To enhance surface profile and substrate absorbability, it is essential to remove loose paint and heavily sand the surface. A bond test is advisable to check adhesive does not react with paint.
- (c) AltroFix W 157 should not be used for bonding to moisture resistant material applied over substrates i.e. water proofing, vapour barriers. AltroFix W 157 is strictly for use in non-wet areas.
- (d) Provided tiles are firmly bonded to the substrate and free from surface contamination, grease, soap, etc. Remove all existing residue using an appropriate degreaser. Rinse the wall thoroughly with clean water and then wipe it down.

Contents

01	Surface Preparation
02	Installation Temperature and Acclimatising Tools and Equipment <ul style="list-style-type: none">Safety EquipmentWork Bench / Workstation
03	Safety Information Methods of Installation <ul style="list-style-type: none">AltroFix adhesive free tape installation systemAltroFix W157 adhesive direct stickAltroFix W157 adhesive & full tape system
06	Setting Out Installation Procedure
07	Fitting the Fortis Titanium Panel <ul style="list-style-type: none">Fitting the Fortis Titanium panel to abutments Thermoforming Internal & External Corners Fortis Titanium Panel Joint Finish <ul style="list-style-type: none">Altro sanitary sealantSilicone seal joint detailHeat welded: weldingHeat welded: trimming off
09	Tools for Welding Wall to Coved Vinyl Wall Junction Detail <ul style="list-style-type: none">Altro sanitary sealant jointOverlap finish
11	Fitting Altro Fortis Corner Protection
12	Maintenance <ul style="list-style-type: none">CleaningTips for successful maintenance of Altro PVCu walling and doorsets

SURFACE PREPARATION

All surfaces must be smooth, sound, dry and free of contamination. If necessary, the walls should be cleaned down prior to the Fortis Titanium 15 installation. The working environment must also be clean and dust free. Failure to comply with these conditions will reduce the bond strength between adhesive and substrate and may cause the panels to de-bond.

All surfaces should exhibit adequate planeness for installation. Walls are deemed unsuitable if they deviate from the plane by more than 4mm within any 2000mm length, including plaster buildup at internal and external corners. The same tolerance is also applied to vertical plumbness.

Walls should be level. High points must be removed, and low points filled with an approved filler. (Consideration should be taken that if the walls are outside acceptable guidelines, then dry lining or rendering with a suitable cementitious patching compound or hardwall plaster should take place).

Plasterboard sheeting should adhere to the standards outlined in AS 2589:2017, with the minimum acceptable finish level being Level 4. (Suitable for low sheen paint finish)

All substrates to be dry to 16% WME on Protimeter 'Surveymaster' equipment.

Prime porous and highly absorbent substrates with a suitable Acrylic Floor & Wall Primer before applying the adhesive. The primers used must be appropriate for the application, and manufacturers' guidelines must be strictly adhered to.

(Note: Non-absorbent substrates are not suitable for water dispersion acrylic adhesives)

All loose flaking paint and dust to be removed.

Friable surfaces to be removed or made sound using proprietary surface treatment.

All surfaces must be smooth, solid, sound, clean and permanently dry. Paint, oil, grease, excessive dust, curing and parting agents or any other contaminants liable to impair adhesion, cause discoloration or any other detrimental effect must be removed, prior to application of the wall covering.

Ceramic tiles must be securely bonded to the substrate, thoroughly cleaned and degreased using a suitable degreasing agent and scouring pad, fully rinsed with clean water and allowed to dry.

Only a qualified electrician should uninstall all electrical fixtures and securely cap exposed wires.

Fittings and hardware should be removed from all plumbing to achieve a first fix state, with "capped tails" extending from the substrate. Fortis Titanium 15 panels can then be drilled and slid over the pipe "tails." It is essential to drill all holes 3mm oversize to accommodate expansion. A qualified plumber should always conduct plumbing tasks.

Fixed hot pipes and steam pipes should be insulated and a 3-5mm expansion gap should be created when installing panels around these pipes.

All pipes, fixings bolts, fixed through the Fortis Titanium panels should have minimum 3-5mm expansion gaps and be sealed using silicone sealant.

INSTALLATION TEMPERATURE AND ACCLIMATISING

Altro recommends the PVCu wall cladding panels are installed at the same ambient 'service temperature' at which the area will be used when commissioned.

A minimum temperature of 14°C is recommended for all installation areas.

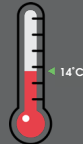

AltroFix W157 must never be used on surfaces or conditions below 10°C.

Panels should be stored flat, off the ground and be pre-conditioned for up to 24 hours to attain the ambient room temperature prior to the installation.

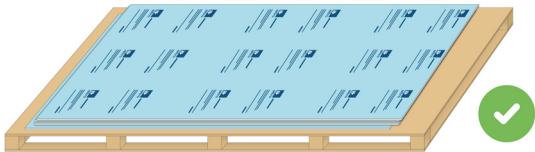

Storage on un-even surfaces could cause the panels to distort prior to installation.



Fortis sheets should only be stored upright for short durations, as prolonged upright storage increases the risk of edge damage and potential tipping.

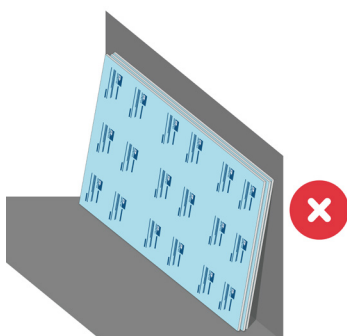

Fortis panels must always be stored, fabricated, and installed indoors. They should not be exposed to direct sunlight through doors and windows until the installation is fully completed.

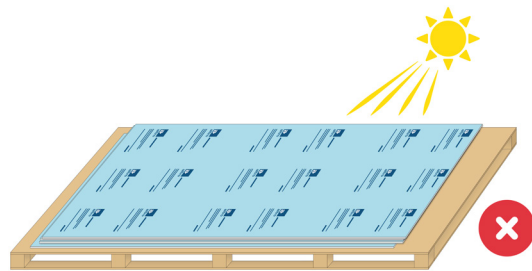

TOOLS AND EQUIPMENT

In general, the main tools required are carpentry based. Below is a list of tools that you may find an advantage to have for the installation.

- 1 metre & 2 metre spirit levels
- Stanley knife
- Square
- Chalk line
- Laser level
- Adjustable block plane
- 5m tape measure
- Hole cutters
- Scrapers
- 50mm paint brush / 100mm paint roller
- Quality mastic caulking gun
- Mixing paddle
- Biro pens and pencils
- Water based markers
- Hand roller
- 3000mm rigid straight edge
- Track saw with fine tooth blade
- Track rail 3000/1500mm
- Vacuum fitted to track saw
- V2 notched adhesive trowel (2.4mm X 2.4mm)
- Thermo former 3000mm
- Jig saw with fine tooth blade

Safety equipment

- Barrier tape
- Goggles / safety glasses
- Protective gloves
- Face mask (nose / mouth protection)
- Hard hat
- Safety boots
- Hi-Viz safety vest
- Ear protection

Work bench / workstation

You will also need a 3.0 x 1.22m workbench made from 18mm MDF board (or similar), with support bearers to prevent the MDF from bowing in the middle. The bench provides an excellent work surface for the panels which are 1.220m x 3.000m

Set up a 'workstation' near the area to be clad. A minimum area of 4m x 3m will be required to set up your work bench area.

Adjacent to the workstation, set up a glue-station. The floor area in this location needs to be protected with cardboard (or similar) to prevent splashes of adhesive getting onto the floor.

If an existing or new floor has been installed before the cladding, it is crucial to protect the floor around the workbench to prevent adhesive spills during the trowelling process. Any spillage should be wiped up immediately.

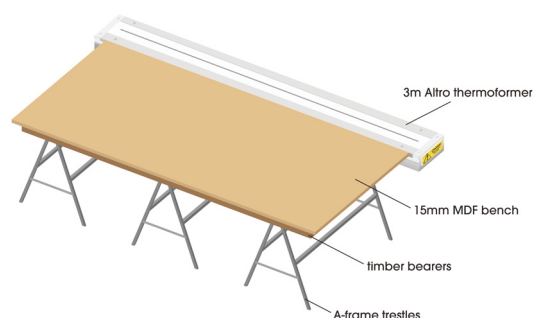

SAFETY INFORMATION

Apart from the normal health and safety rules employed within the construction industry, the following points should be noted:

- Safety information displayed on the tubs and containers supplied by Altro must be strictly adhered to.
- Safety eye wear must be worn during cutting of materials, mixing of adhesive, cleaning, and preparation of site, and where necessary to adhere to site regulations.
- Use face masks.
- Display prominent safety signs when using hazardous materials, and to warn of a working area.
- Ensure good ventilation within the work area.
- Remove and dispose of all waste sensibly and carefully as per site instructions. Contact Altro on 1800 673 441 for all MSDS (Material Safety Data Sheets) and OH&S requirements.
- Apply barrier creams and wear protective gloves when stirring and applying AltroFix adhesives.
- Keep the working area clean and tidy.

METHODS OF INSTALLATION

Altro provides three installation methods and two seam finish options:

- Option 1: Adhesive-free installation with a silicone seam joint.
- Option 2: Installation using AltroFix W157 applied to the wall, finished with a silicone, or welded seam joint.
- Option 3: Installation using AltroFix W157 combined with the Altro full tape system, featuring a welded joint finish.

AltroFix adhesive free tape installation system

Altro offers an adhesive-free installation solution using high-performance double-

sided tape for a secure and reliable finish. AltroFix Adhesive-Free Tape allows panels to be fixed to smooth, stable, and dry substrates without the need for traditional adhesives. This method is ideal for single-sheet applications such as bedheads and splashbacks.

Note: It is only suitable for dry areas and should not be used in environments subject to high impact.

AltroFix Fortis adhesive free Tape should be applied to all perimeters of the Altro Fortis Titanium 15 and in a grid pattern at a minimum 500MM centres. Apply the Fortis adhesive free Tape to the wall or on the back side of the Altro Fortis Titanium 15 (preferred) and press on firmly, roll using a hand roller.

On porous surfaces, apply Altro primer to all areas where the tape will be applied to the sheet

Remove silicone release paper from adhesive free Tape and apply the Altro Fortis Titanium 15 to the wall without tension. Roll the Altro Fortis Titanium 15 firmly into place with a wall roller.

The adhesive free tape adhesive bond gets stronger through rolling and ensures the material is firmly bonded in place.

The adhesive bond will get stronger over time.

To achieve a permanent bond, work in accordance with these installation instructions

Allow a 4 mm gap between joints and finish with Silicone.

Note: When ordering please reference the following codes:

Altro W165 primer: A816/01

Adhesive free tape: XLTAPE25

Altro sanitary sealant: A805FT/colour

AltroFix W157 adhesive direct stick

An installation that can be completed by any competent installer. All corners are sealed with silicone at internal junctions, and separate pre-formed external guards are fitted over the external corners.

The panels can be fixed to most smooth, sound, dry and porous substrates with AltroFix W157 single part acrylic water based synthetic polymer emulsion adhesive. The adhesive is available in 15kg units (ref: A818/15).

To install the panel, use a V2 adhesive notch (2.4mm x 2.4mm) to apply adhesive evenly across the entire wall area to be covered. Allow adequate time for the adhesive to tack off, which will vary depending on environmental conditions. On average, this timeline is around 10 minutes. Check regularly that ribs are still pliable and have not hardened.

Once applied, cover the area with the panel and use a wall roller or a suitable non-scratching push board to eliminate all air bubbles. Ensure full adhesive transfer to the panel.

It is crucial to flatten all adhesive ribs during this process. Failure to do so will void the warranty.

Proper installation is essential to ensure a durable and long-lasting bond. By following these steps, you will achieve a secure and professional finish that meets Altro's quality standards.

Allow a 4 mm gap between joints for a Altro sanitary sealant joint finish or a 2 mm gap for a welded finish. Thermal welding must be undertaken after 24 hours to allow the adhesive to cure. Seams must be clean and free of any adhesive residue.

Note: When ordering please reference the following codes:

AltroFix W157: A818/15

Altro sanitary sealant: A805FT/colour

AltroFix W157 adhesive & full tape system: welded seam finish

This system, which uses Altro double-sided, and weld tapes, allows Fortis to be thermally welded immediately after installation. It also reduces the tack-off time needed for the acrylic adhesive, leading to a quicker overall installation process.

Note: This installation method is only recommended after completing the Altro "Whiterock Installation Training" course. The course also includes training on thermally forming internal and external corners.

Altro W165 tape primer should be applied to the substrate using a 50mm paintbrush. The primer should be applied in lines that correspond to the placement of the double-sided tapes, which will later be attached to the reverse side of the panel—at the top, bottom, and along all edges of the Whiterock Fortis Titanium 15. Wipe down the back of the Fortis Titanium 15 sheet to ensure it is clean.

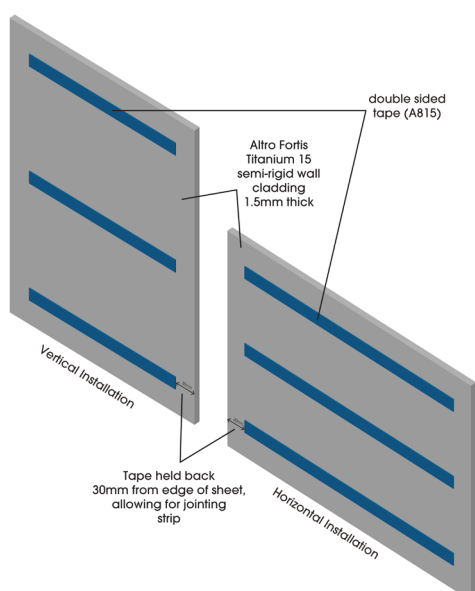

Additionally, W165 primer must be applied to the substrate where the foam welding tape will be installed. The weld tape is then applied to the wall, ensuring it is positioned at the centre point of the walling junction.

The diagram below details this joint structure.

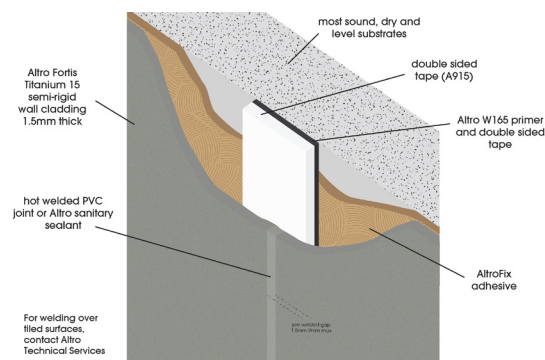

Using a V2 notch (2.4mm x 2.4mm) apply adhesive to the back of the Fortis panel. The tack-off time is reduced, as the double-sided tape holds the sheet in place during the curing process. Allow 4-6 minutes before proceeding with the installation.

Once applied, cover the area with the panel and use a wall roller or a suitable non-scratching push board to eliminate all air bubbles. Ensure full adhesive transfer to the panel.

It is crucial to flatten all adhesive ribs during this process. Failure to do so will void the warranty.

After the sheets have been fitted and rolled, the seam edges can be finished. Begin by removing the protective silicone release paper. To do this, gently cut along the edge of the Fortis sheet, ensuring that only the protective layer is cut without damaging the foam welding tape. Pull back the top of the sheet to remove the protective layer, exposing the foam tape. Then, use a hand roller to firmly bond the sheet to the welding tape, which has already been pre-adhered with adhesive.

A consistent 2mm gap is required for welding. To ensure this gap is maintained

throughout the installation, a 2mm spacer should be used.

Note: When ordering please reference the following codes:

AltroFix W165 primer: A816/01

AltroFix W157: A818/15

Altro sanitary sealant: A805FT/colour

1mm black Butyl double sided tape: A815/30

1mm foam Welding tape: A915/50

SETTING OUT

Firstly, check out the room, which is to be clad, paying particular attention to the corners, window reveals, and door entrances. These need to be inspected to ensure they are straight, and free of any building waste which could prevent the panels lying flat to the substrate after the adhesive has been applied and the panel is installed.

The wall surface must be clean prior to installation (if necessary, contact Altro Technical for specific recommendations on cleaning and preparation).

Once preparation has been completed a datum line (horizontal top installation line) must be installed on the wall. The datum line is used for the calculation of measurements for the height, sockets, and pipes and to ensure the panels are 'plumb' as the installation proceeds. Use a laser level to apply the datum line accurately.

The datum line height (from subfloor) should be calculated to allow for the appropriate skirting height where the bottom of the PVCu panel meets the specific floor finish (sheet PVC flooring, quarry tiles, PVC sit-on skirting). Note: Ceramic tile skirting must always be installed before the wall cladding is fitted.

A series of 'check measurements' should be taken around the room from datum to

subfloor to ascertain the 'average' height of the datum line. The datum height (minus the appropriate floor skirting height) will eventually be transferred on to the face of the PVCu wall panel. This will enable all subsequent measurements to be processed from the datum line on the panel.

Once all measurements have been taken from the wall, they can then be transferred on to the panel. When the panel is eventually fitted to the wall, the top edge of the panel must line up with the datum line on the wall.

After installing the datum line and calculating the average height, you must then plan the 'layout' of the PVCu Fortis Titanium 15 panels. This ensures the best layout of the panels and minimises the number of joints used in the system.

INSTALLATION PROCEDURE

After completing all preparations—ensuring the walls are clean and free from dust, removing any contaminants that could affect adhesion, applying the datum line, and applying the tape primer—you are ready to install the Fortis Titanium panels.

Place panel on the workbench and inspect for any damage.

Take measurements from datum line on the wall, and then transfer these to the panel. Cut the panel making sure the panel is well supported to reduce any risk of stress in the material when being cut.

The most effective way to cut Altro Fortis Titanium 15 is with a track guided circular saw. The blade used to cut the panel should be carbide tipped with a minimum of 40 teeth.

After the final cutting, plane the edges with your adjustable block plane to remove burrs and to leave a clean smooth finish.

Offer the panel to the substrate to check your work (dry fitting), ensuring you have 2-3mm expansion joint at all abutments and pipe work.

Ensure you have 3-4mm expansion joint at all panel-to-panel joints for application of silicone joint sealant, including internal and external corner junctions.

FITTING THE FORTIS TITANIUM PANEL

Installation is ideally suited to two installers.

After applying the adhesive to the wall (if applicable), allow sufficient tack off time before proceeding. Lift the panel and install to the required location, ensuring the top edge of the panel corresponds to the datum line on the wall.

Once fitted to the substrate, apply pressure to the whole of the panel face to ensure the adhesive has been transferred and will be fully bonded to the substrate (this is normally done with a hand roller or block of timber covered with a material to prevent the surface being damaged).

Failure to ensure a good transfer of adhesive to the substrate could result in the panel debonding.

Ensure any adhesive residue is thoroughly cleaned off the surface of the panel or joint trims (and other adjacent surfaces).

This must be done immediately, before the adhesive sets.

Fitting the Fortis Titanium panel to abutments

Altro Fortis Titanium panels should be fitted to within 3mm of rigid abutments such as window frames, door frames, architraves, ceilings, ceramic tile skirtings, thus ensuring a 2-3mm gap at these points.

This will allow for expansion and contraction to take place. Prior to sealing the joint, clean the panel and adjacent surfaces.

All 'isolation' joints must be sealed with colour coordinated Altro sanitary sealant.

THERMOFORMING INTERNAL & EXTERNAL CORNERS

The thermoforming of Altro Fortis Titanium 15 can be accomplished using an Altro Thermoformer. **For proper thermoforming method please consult the Altro Whiterock Installation Guide.**

Pre-thermoformed corners can be manufactured on-site and installed to suit the installation system prior to installing the full (field) sheets of Altro Fortis Titanium 15

To minimise joints, it is recommended that only outside corners are thermoformed, inside corners can be fitted and sealed with silicone sealant.

FORTIS TITANIUM PANEL JOINT FINISH: DIRECT STICK METHOD

Altro sanitary sealant

The panels should be installed with a 3-4mm gap. Altro recommends using masking tape on the front face of the panels to counteract overspill and protect the surfaces.

Ensure the edges of the panels are clean prior to silicone application.

Place tube of Altro sanitary sealant into caulking gun.

Cut off the end of the tube nipple, fix the nozzle and apply a bead approximately 3mm in diameter.

Ensure sufficient sealant is pumped into the joint so that it forms up against the edges of the panel and double side tapes on the reverse of the panel if using the alternative AltroFixW157 system.

Once completed, tool off the surplus to leave a neat, flush, sealed joint. Remove masking

tape immediately sealant is smoothed away to reveal clean edges.

Silicone seal joint detail

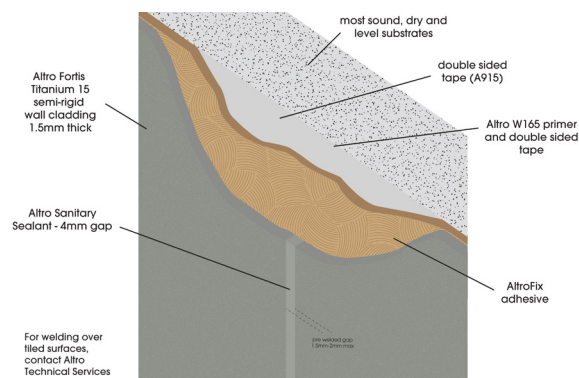

Heat welded: welding

Firstly, ensure your weld rod and the joint gap to be welded is clean and free of adhesive and any other contamination. Adhesive must be dry before proceeding. A 2mm-2.5mm gap must be left between joints for a welded finish. No grooving is required but gap must be consistent throughout the seam.

The hot welding technique used to weld Whiterock panels is basically identical to that used in vinyl floor laying. The same type of tools and welding gun can be used. (See attached tools list)

The weld rod is passed through a standard 5mm 'speed weld nozzle' which softens the weld rod and panel edges simultaneously to fuse the materials together under heat.

The temperature of the weld gun can be regulated, and the settings depend on the speed at which you travel along the panel. Installers should practice this to determine what best suits their working method.

The typical welding speed is approximately 2 metres per minute; however, this is not always practical when working vertically, so you must practice to gain experience of different situations.

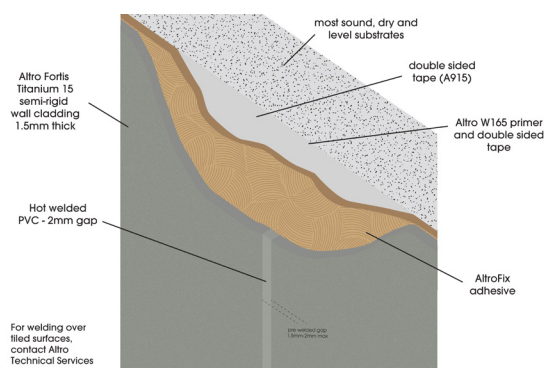

Heat welded: trimming off

The trimming process, like flooring, should be completed in two passes. The use of lubricant (soapy water sprayed onto the welded area) will reduce any scratching to the Fortis surface during this process. (Recommended trimming tools below)

The first pass must be done by using a 'trimming guide' and spatula to take off half of the weld rod. This allows the weld rod to 'settle' and will prevent sinking into the joint once the rod has cooled.

After pre-cutting the weld rod, allow the rod to cool down sufficiently before completing the final trimming.

Once the rod has cooled down (cold) you can commence final trimming with an appropriate trimming tool.

TOOLS FOR WELDING



WALL TO COVERED VINYL WALL JUNCTION DETAIL

A silicone joint or overlap system is recommended for the wall-to-floor junction detail.

Altro sanitary sealant joint

For this method, the Fortis Titanium panel should be installed first. It is crucial that sheets are level and that the bottoms of all sheets are flush.

As you install the Fortis Titanium panels, ensure that the area below the sheets is clean, free from adhesive and that the panels are flat and securely bonded to the wall substrate.

The combined thickness of the panel lining, and adhesive, should be approximately 2mm. This thickness ensures a smooth transition to 2mm covered vinyl flooring.

The flooring is now ready for installation. After the coving has been adhered and is

ready for trimming, set a scribe to a 4mm spacing and scribe along the Fortis titanium. Then, cut and roll the flooring, ensuring a smooth and seamless transition to the wall.

The 4mm transition gap is now ready to be filled with Altro sanitary sealant. This task should be performed by a skilled tradesperson to ensure a smooth, flush application. The finish must be clean, with no excess silicone on any of the material surfaces.

Overlap finish

For this application, the flooring and coving must be completed prior to installation. The coved vinyl should extend 30mm above the intended finished cove height to allow for a 30mm panel overlap. Utilising a laser to cut the cove level ensures accurate alignment of the Fortis panels, eliminating the need for extra trimming or re-squaring.

Using a string line, mark a level line 30mm below the top of the coved vinyl where the Fortis panel will overlap and finish. Before fitting any panels to the wall, a 1mm PVC wedge fillet must be installed at the top of the vinyl cove to ensure a smooth transition over the coved vinyl. This transition should span approximately 50mm to create a seamless overlap (Figure 1).

Figure 1.

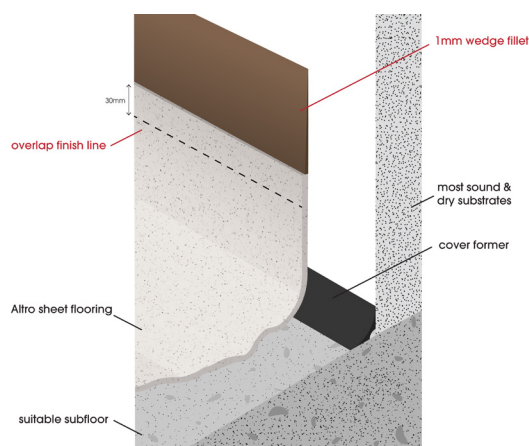

At the apex of the cove and over the previously installed wedge fillet, apply a 1mm butyl tape strip along the upper edge of the coved vinyl. Use a hand roller to exert

uniform pressure, ensuring adhesion and eliminating air pockets. The butyl tape must be precisely aligned, maintaining a flush fit with the coved vinyl for a secure and seamless finish (Figure 2).

Figure 2.

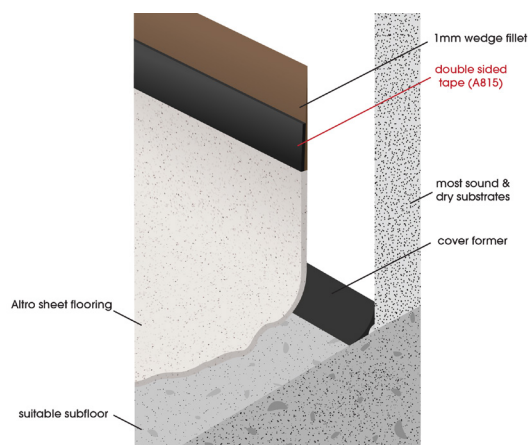

AltroFix W157 adhesive can be applied either to the reverse side of the Fortis sheet or directly to the substrate. Ensure compliance with the recommended tack time specified in the Technical Data Sheet (TDS) before proceeding with installation. (Figure 3).

Figure 3.

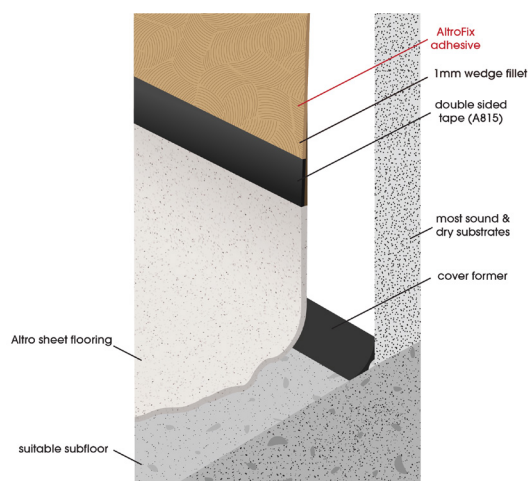

To bond the Fortis panelling to the coved flooring, use adhesive-free tape combined with Primer W165 for a strong and durable finish. This method is both non-flammable and odorless. Apply the primer to the flooring from the marked line up to the top of the cove where the Fortis panel will overlap. Additionally, apply primer to the corresponding overlapping area on the Fortis

panel. Once the primer has dried, apply the adhesive-free tape to the primed vinyl surface and remove the protective covering (Figure 4).*

Figure 4.

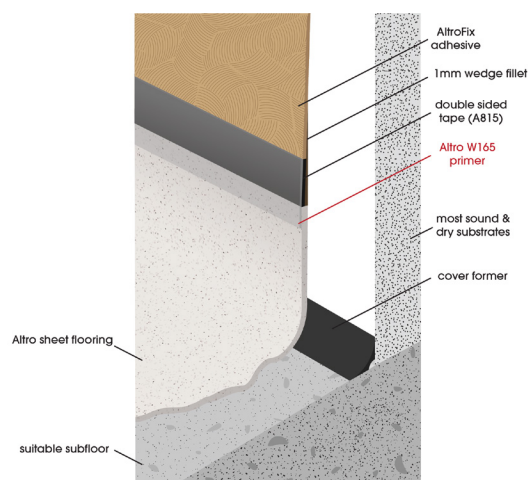

Remove the protective liner from the butyl tape, ensuring no contamination of the adhesive surface. Carefully align and position the sheet against the substrate, maintaining accurate placement. Using a hand roller, apply consistent pressure across the entire surface to achieve uniform adhesive distribution, full substrate contact, and the elimination of air entrapment. Ensure all edges and corners are securely bonded (Figure 5).

Figure 5.

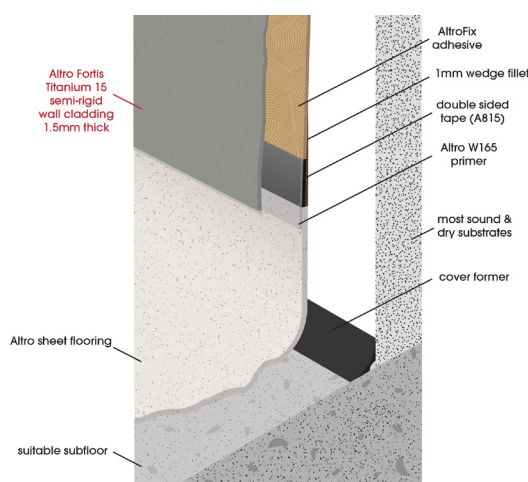

*Note: When attaching the Fortis panelling to the coved vinyl, a contact adhesive may be used at the installer's discretion. If opting for a solvent-based contact adhesive, ensure all necessary safety measures are in place before

starting. Always adhere to the adhesive manufacturer's installation guidelines to achieve a secure and reliable bond.

Note: When ordering please reference the following codes:

Altro W165 primer: A816/01

AltroFix W157: A818/15

Altro sanitary sealant: A805FT/colour

1mm black Butyl double sided tape: A815/30

Adhesive free tape: XLTAPE25

FITTING ALTRO FORTIS CORNER PROTECTION

Corner protectors are manufactured in coordinating colours to match the Altro Fortis Titanium range of cladding systems. When ordering colour coordinated corners, remember to include the 'part number' with the specific 'colour reference number' on your order. (REF: FT/XXX/E75x75)

Preparation - prime the wall with the Altro W165 primer sufficiently enough to cover the area that the corner protectors are to be installed. Allow the primer to dry to provide a tacky surface.

When the walls are ready for application, double sided tape should be applied to the back of the corner protectors down the corner length. The void in-between the tape should be filled with Altro sanitary sealant (ref. A802/A803) or AP600 adhesive.

Remove the protective cover from the tape and apply the corner to the substrate. A bead of Altro sanitary sealant should be applied to both sides of the corner profile (on the inner faces). This will prevent the panel from having a void where the tape stops short of the panel edge (see diagram).

The front covers should initially be positioned by hand pressure. They can then be rolled to ensure adhesion, and any excess silicone tooled off.

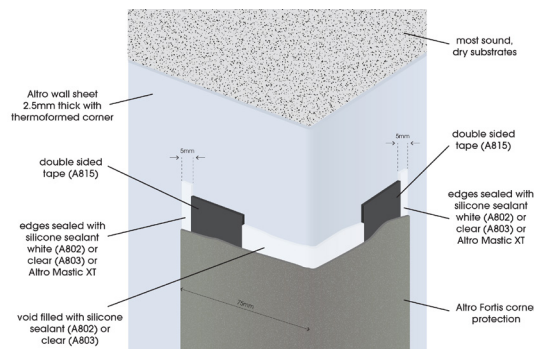

Note: When ordering please reference the following codes:

Altro Fortis guards 150mm wide:

FTCGXXX/150/XXP (Please refer to Altro Fortis Guard price list for size options)

Altro Fortis guards 75mm wide:

FTDF122/150/XP (Please refer to Altro Fortis Guard price list for size options)

Altro W165 primer: A816/01

Altro sanitary sealant: A802 (Inner face void filling)

Altro sanitary sealant: A805FT/colour (for sealing the perimeter)

1mm black Butyl double sided tape: A815/30

MAINTENANCE

Manual - weekly

1. Wash with water or diluted soap / detergent solutions. Follow the manufacturer's dilution instructions.

Use a soft cloth only. Do not use abrasive cleaners, pads or wire wool.

Sterilisation and pressure cleaning

1. Sterilisation solutions (supplied by others) may be used following the manufacturer's instructions.
2. Pressure cleaning with hot water lance may be carried out with the pressure nozzle a minimum of 600mm (approx 2 feet) from the wall surface.

NB Observe maximum temperature of 60°C on all Altro PVCu products.

Heavy or stubborn stains

1. Clean heavily soiled areas with AltroClean™ 44 cleaner or equivalent alkaline cleaner.
2. Remove stubborn stains with Altro Whiterock Cleaner A859*.

*NB Not to be used on Altro Whiterock Chameleon™, Altro Whiterock Digiclad™ (Custom) or Altro Whiterock™ wall designs (including Altro Tegulis using Altro Whiterock wall designs).

Dusty environments

1. Altro Whiterock antistatic solution A809 to reduce static charge after cleaning, apply Antistatic Solution A809 to all surfaces when dry.

Failure to maintain Altro products in accordance with recommended procedure can affect performance. Further information is available from Altro.

Before using any cleaning chemical, users should refer to the SDS (Safety Data Sheet) for correct safety advice and to determine the level of PPE (Personal Protective Equipment) and RPE (Respiratory Protective Equipment) that is required.

A COSHH (Control of Substances Hazardous to Health) assessment and risk assessment should be carried out before using the cleaning chemical. In the case of contact with eyes or skin, rinse immediately with plenty of water and seek medical advice. For further information see SDS available from Altro. In the event of any queries, our Technical Services Department will be pleased to advise you.

Tips for successful maintenance of Altro PVCu walling and doorsets

1. **Develop a regular cleaning programme suited to the usage and traffic of the area** – heavy traffic or highly visible areas, or locations with rigorous hygiene requirements, need to be cleaned more often than areas which are seldom used, or where appearance is less important. A weekly cleaning programme is the minimum recommended.
2. **Use recommended cleaning chemicals** – use only recommended cleaning liquids, their equivalents or sterilising solutions in the correct concentration. Do not mix cleaning chemicals together, and always follow the manufacturer's instructions.
3. **Remove scuff marks and heavy soiling regularly** – marks and soiling should be removed more often than the maintenance programme, e.g. daily. Never use abrasive pads or cleaners.
4. **Hot water lances can cause damage** – use with care and never closer than 600mm or above maximum temperature recommendations.

High quality cleaning chemicals ensure efficient maintenance and represent only a small proportion of maintenance costs.

This image shows a single sheet of white paper with horizontal ruling lines. The lines are evenly spaced and run across the width of the page. There are no margins, text, or other markings on the paper.

