

Altro Whiterock with epoxy flooring

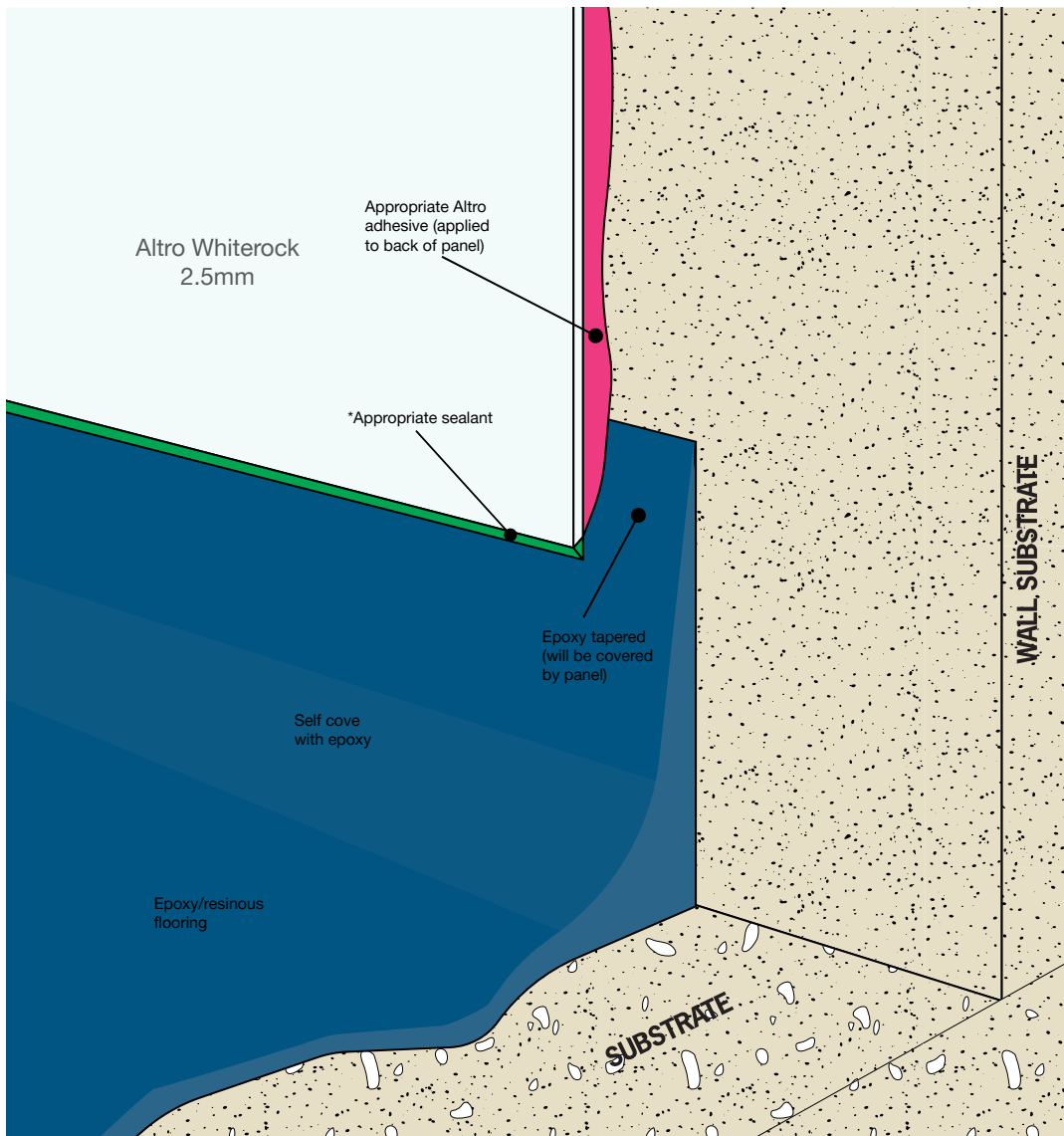

An overlap transition from wall to floor is our preferred installation method and is utilized in most installations, particularly in wet environments. It is completed by installing the epoxy resinous flooring 6" – 8" up the wall, dependent on specified cove height and installing the Altro Whiterock with a 2" overlap. The juncture is then finished with Altro sanitary sealant or tamper-resistant security sealant.

**In behavioral and mental health facilities, tamper-resistant security sealant must be used per the manufacturers instructions. In other installations we recommend Altro sanitary sealant.*

Note: All terminating edges of Altro Whiterock that are not being heat welded are to be Chamfered/Beveled on both front and back edges so as to remove any sharp edges and to allow the greatest surface area for the application of Altro Sanitary sealant.