

# Altro PVCu wall sheet to Altro resin flooring detail

typical specification (Ref: WF5)

Altro resin flooring applied first (to thickness recommended for type/application) and covered up the wall to form a skirting a minimum 100mm high and maximum 4mm thick at the top. Ensuring the top is set perfectly level straight and of even thickness throughout.

Altro PVCu wall sheet 2.5mm thick installed over most sound,

dry substrates. Maintain 7mm gap above top edge of resin, install Altro transition strip (G832) incorporating neoprene seal with 5mm gap between wall sheet bottom edge and centre web of strip, seal over resin edge with clear silicone sealant (A803).

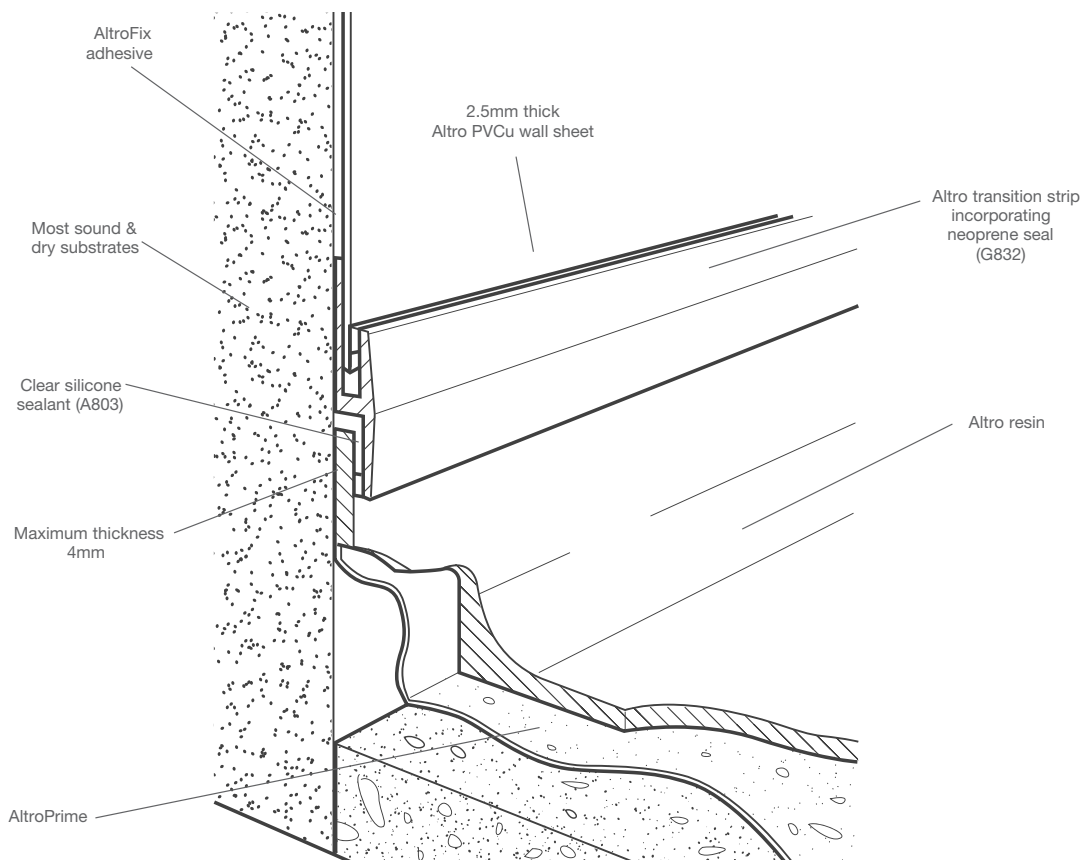

**For further information or technical advice**

**tel: 01462 707600**

**email: [enquiries@altro.com](mailto:enquiries@altro.com) or [www.altro.com](http://www.altro.com)**