

altro

# Altro Fortis Titanium 15 fire door accessories Full door fascia installation

updated 11/29/23

A step-by-step illustrated guide to installing Altro Fortis Titanium 15 full door fascia

Additional technical documentation and maintenance guides are available online at [altro.com/techdocs](https://altro.com/techdocs)

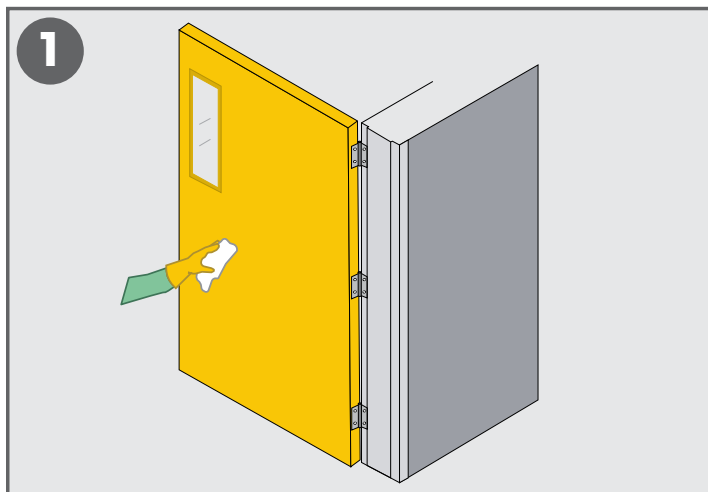

1. Start off by cleaning the door surface. The substrate must be clean and dry, free from dust, dirt, grease, oils, solvents, loose paint or any other contaminants.

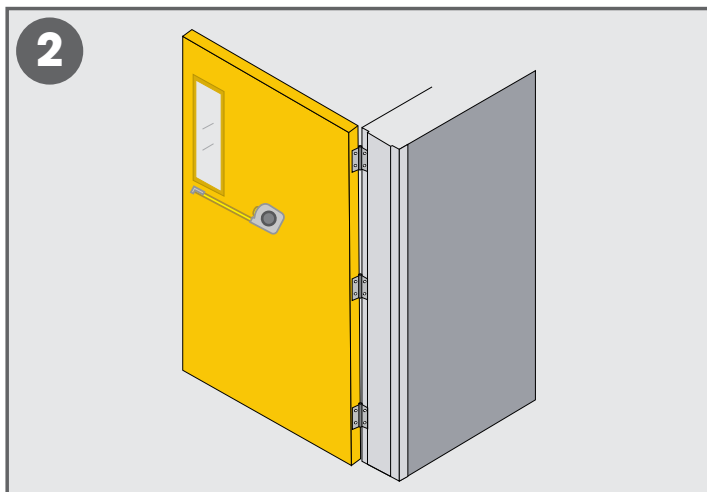

2. Take measurements of door as well as window locations, if applicable, as the panel must leave a 1/16" reveal. AFT Fascia will come pre-cut with window reveal. Dry fit panel to ensure proper fit, make adjustments if necessary.

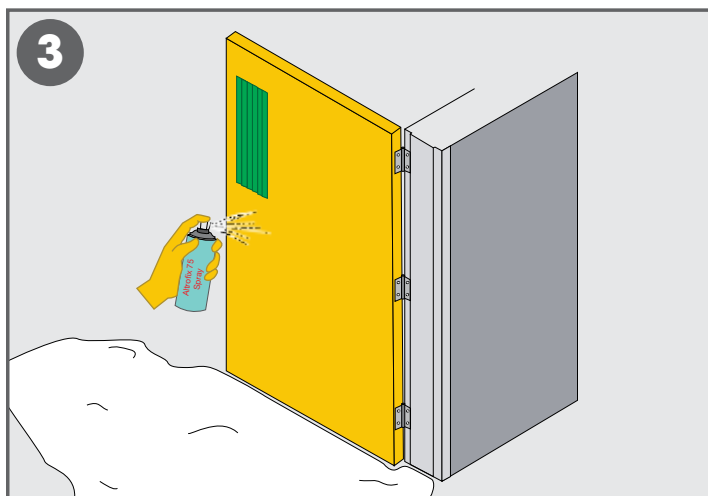

3. Use a drop cloth and also mask the window and surrounding door area to protect from overspray. Spray the door surface with AltroFix 75 Spray. Hold can 6"-10" from material. Allow adhesive to dry to the touch.

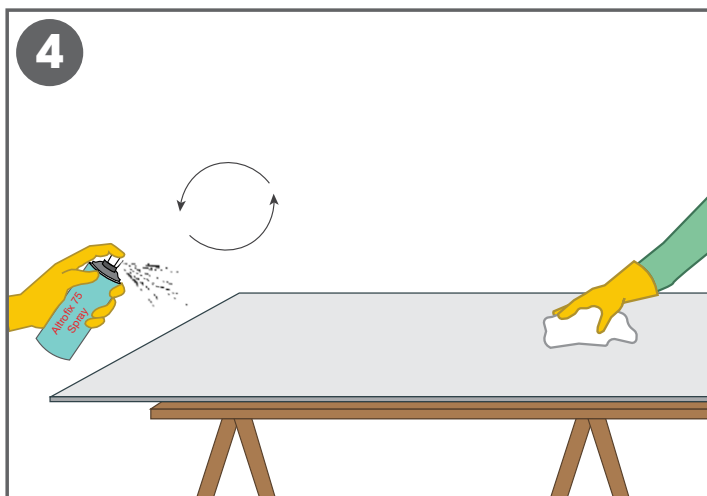

4. Clean the back of the panel with isopropyl alcohol or similar to remove dust and contaminants. Next use AltroFix 75 spray adhesive on entire back side of panel. Allow adhesive to dry to touch.

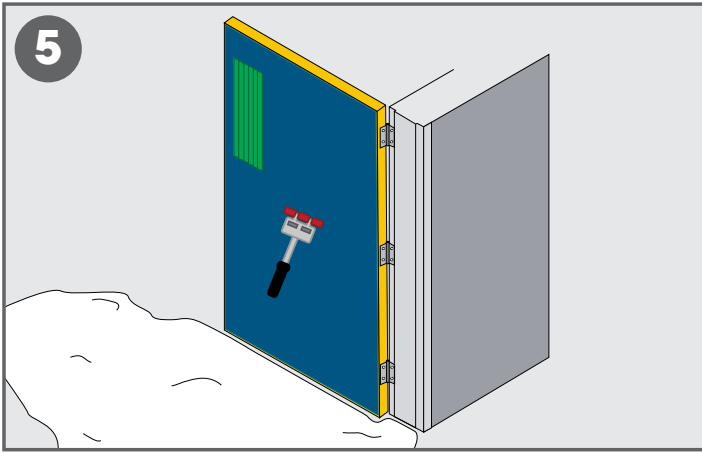

5. Once the adhesive is dry, position the door fascia in place. Roll entire panel with a hand roller to ensure it is fully adhered.

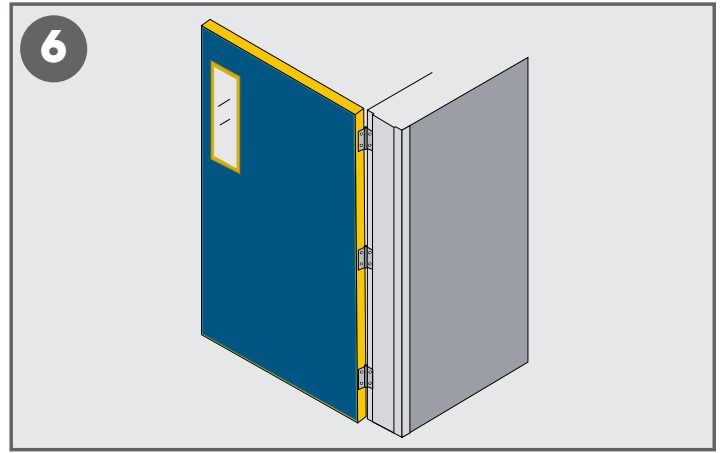

6. Once rolling is complete, finish the installation by removing all masking tape from the door.