



altro

Altro Whiterock™ hygienic PVCu wall cladding to Altro safety flooring detail (welded)

MAY 2006

typical specification (Ref: WF7)

Altro Whiterock hygienic PVCu wall cladding 2.5mm thick installed over most sound, dry and level substrates to minimum 100mm height from floor, fixed with AltroFix™ W139 (A814) or W173 (A820) adhesive and double sided tape (A915), overlapping PVC infill section (WSBU 200). Infill to be suitably positioned behind wall cladding to

accommodate the various flooring thicknesses. Altro safety flooring (2mm/2.5mm/3mm/4mm) fitted over cove former (C38R/C20R) and finished to PVCu cladding with pre-grooved, hot welded joint as per Altro installation recommendations.

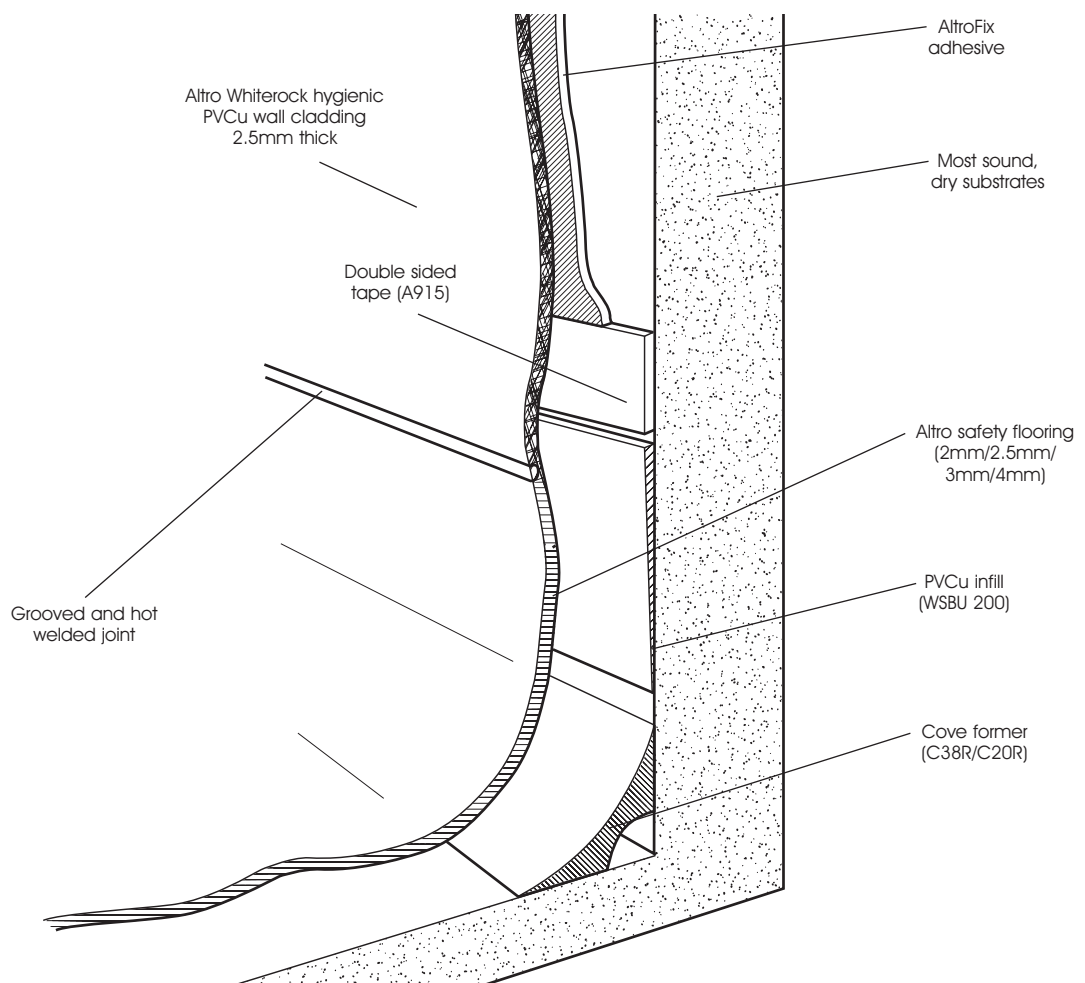

for further information or technical advice

tel: 01502 561364 fax: 01502 531461

e-mail walls@altro.com or explore www.altro.com