

altro

## Heat welding Altro Whiterock to resilient flooring

The key to heat welding at this floor to wall panel juncture is to have both the wall panel and the flooring be flush with each other, including having a solid backing behind both the panel and the floor. This is accomplished by using the WSBU200 Vinyl Backer.

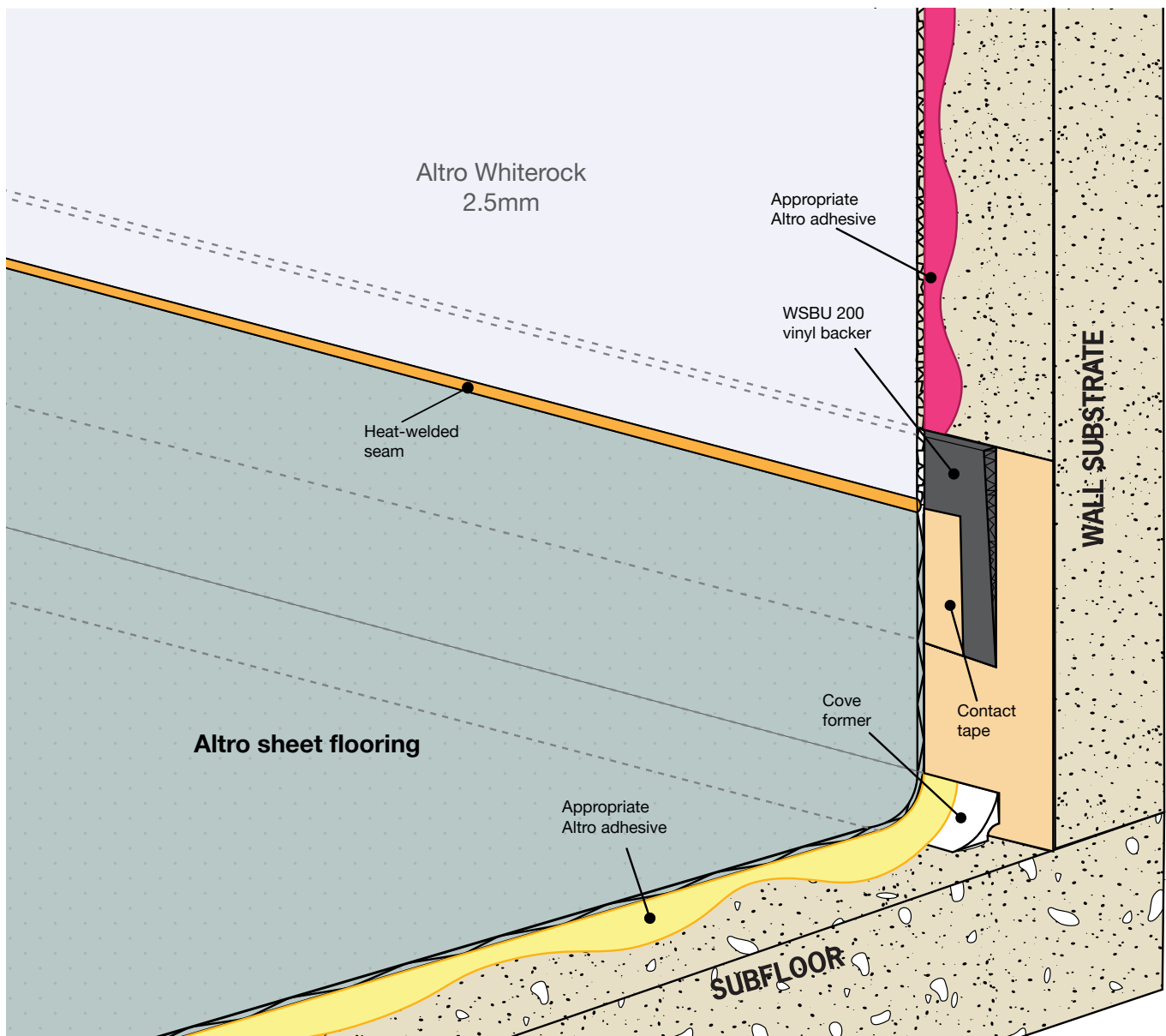

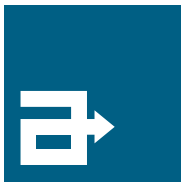

altro

## Altro Whiterock overlaps epoxy flooring

When installing Altro Whiterock and epoxy flooring, Altro recommends that the epoxy be poured and covered between 4" and 6". The epoxy should also be feathered from the 4"/6" cove to net zero up the wall. Once the epoxy has fully cured, Altro Whiterock can be installed over the epoxy.

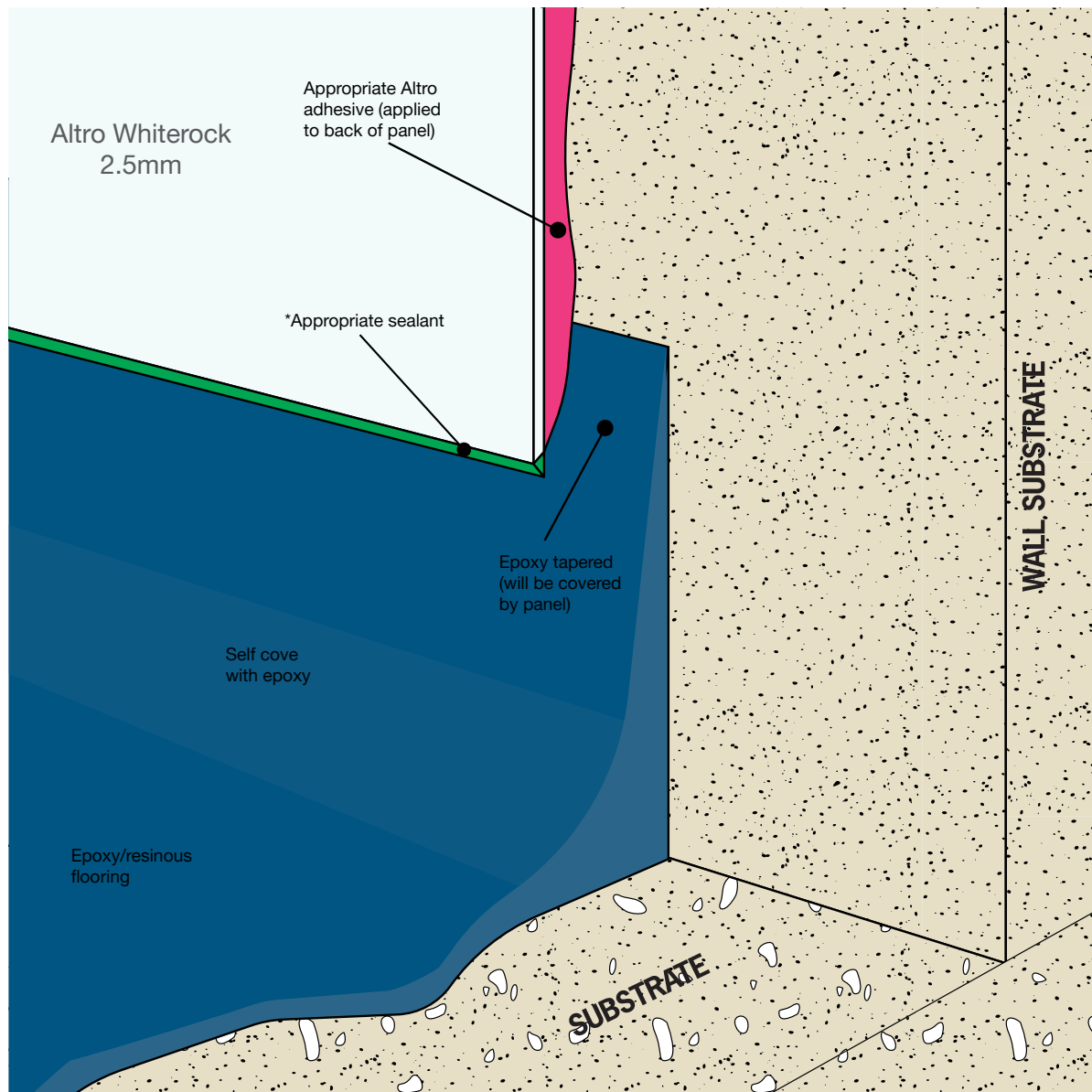

# Floor to wall overlap transition

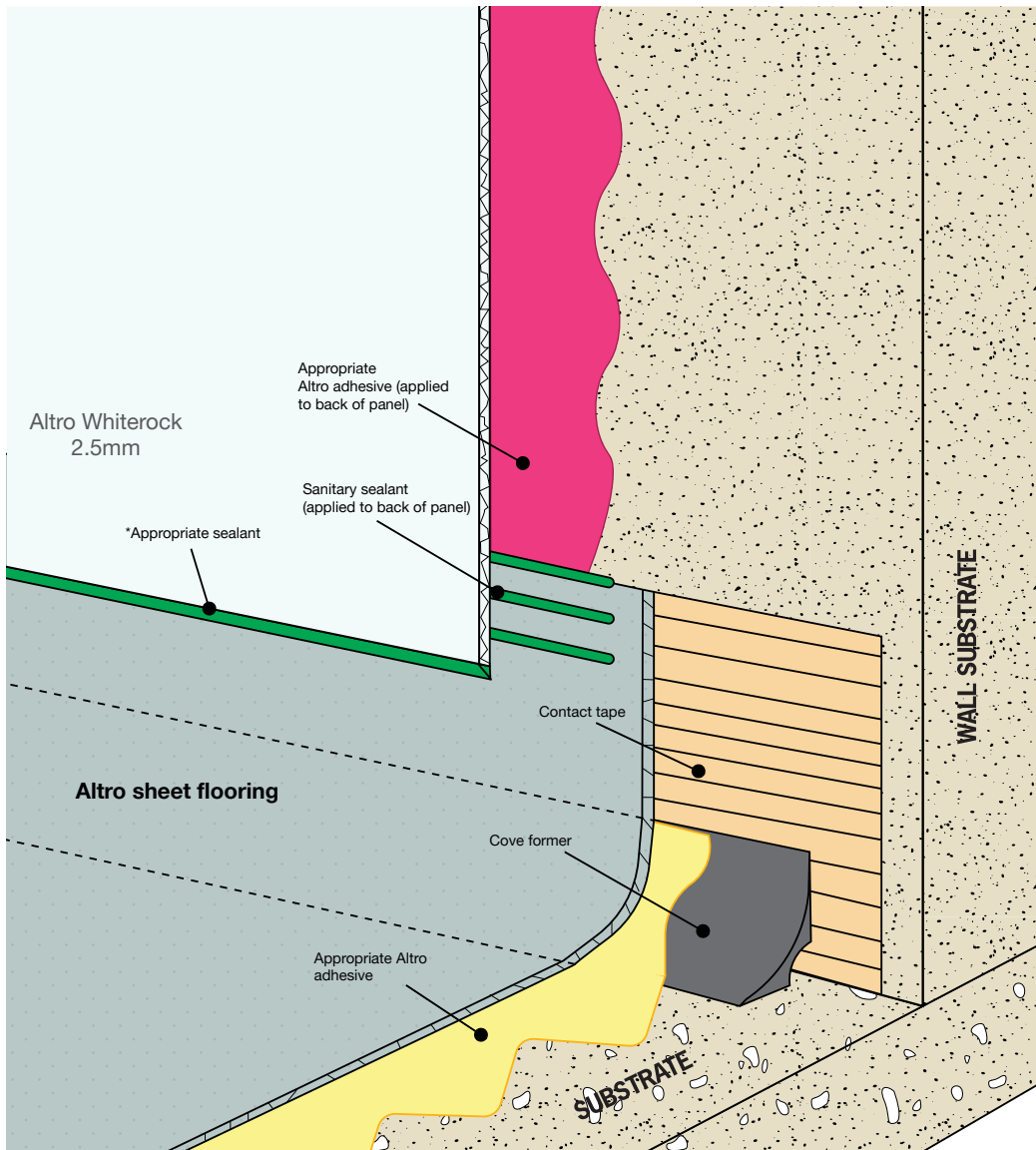

An overlap transition from floor to wall is our preferred installation method and is utilized in most installations. It is completed by installing the flooring 6" – 8" up the wall, dependent on cove size and installing the Altro White Rock with a 2" overlap. The juncture is then finished with Altro sanitary sealant or tamper-resistant security sealant.

This installation technique is easier to install versus a heat-welded transition and offers enhanced security over water ingress.

*\*In behavioral and mental health facilities, tamper-resistant security sealant (previously referred to as pick-proof caulking) must be used per the manufacturers instructions. In other installations we recommend Altro sanitary sealant.*

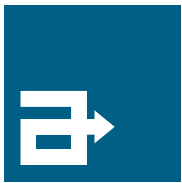

altro

## Terminating Altro Whiterock™ at true ceiling wall intersection

Altro Whiterock installed over drywall using AltroFix W39 adhesive, terminating at true ceiling and sealed with Altro Whiterock sanitary sealant at top of panel.

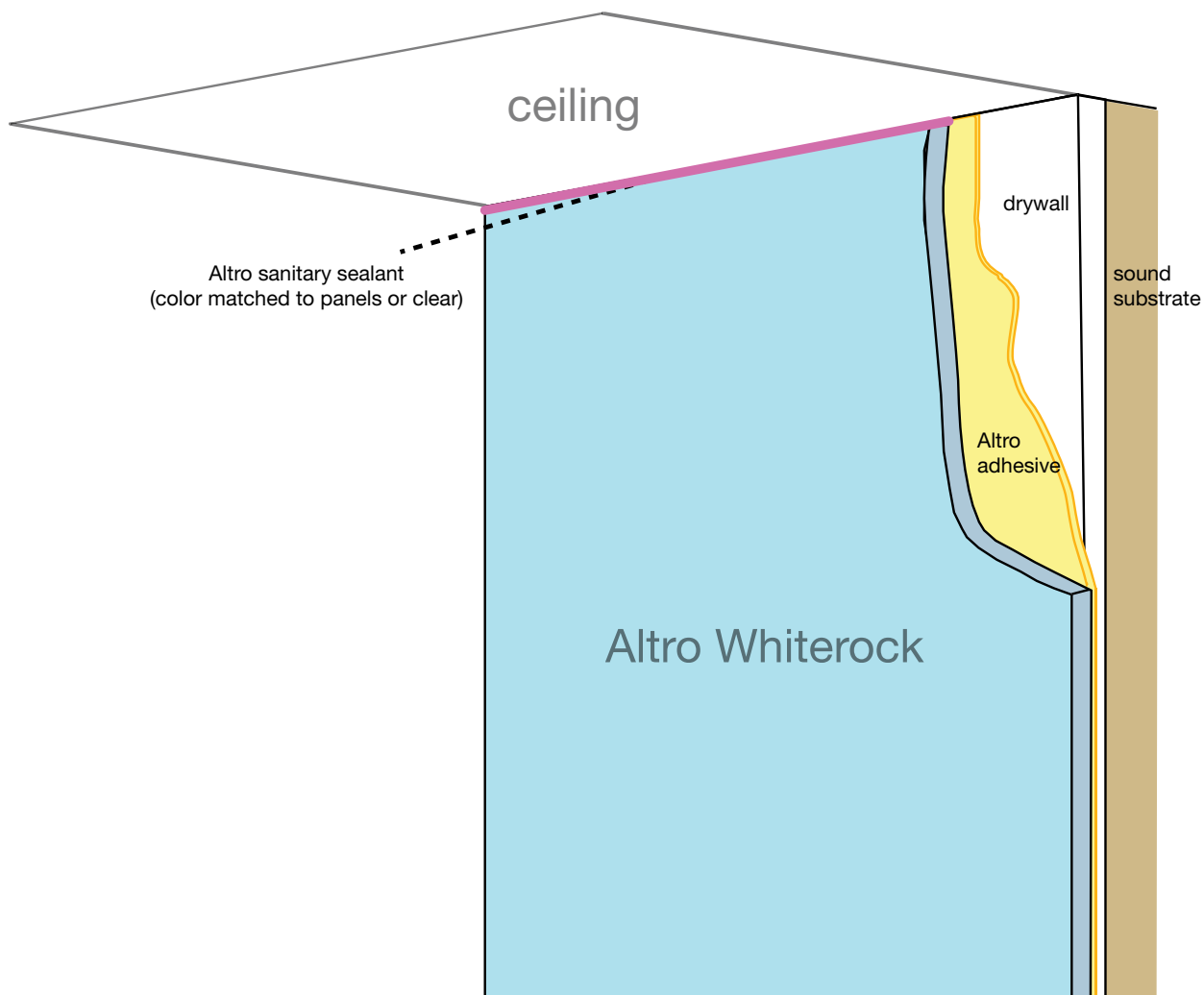

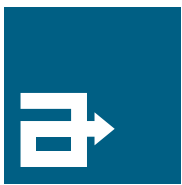

altro

## Terminating Altro Whiterock™ at drop ceiling grid

Altro Whiterock installed over drywall using Altrofix W39 adhesive, terminating at drop ceiling grid and sealed with Altro Whiterock sanitary sealant at top of panel.

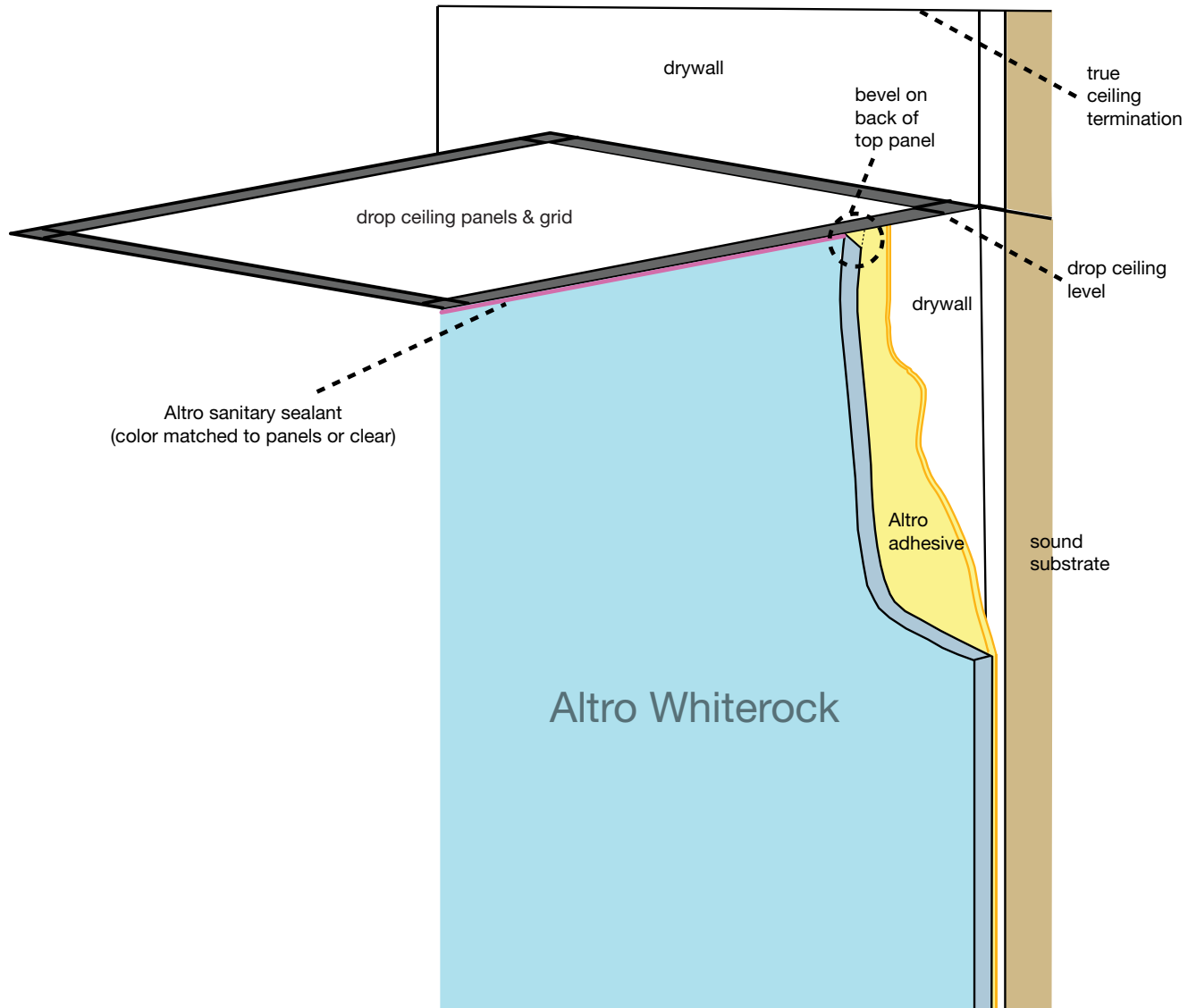

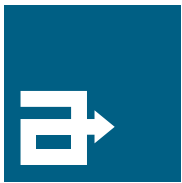

altro

## Terminating Altro Whiterock™ above a drop ceiling grid

Altro Whiterock installed over drywall using Altrofix W39 adhesive and continuing through drop ceiling grid level

When this installation occurs the ceiling grid must be installed to allow for expansion and contraction of the wall panel.

This can be achieved by first making a pilot hole slightly larger than the fastener through the panel and then fastening the ceiling grid to the substrate.

